

#5B



TOWN OF NEWBURGH POLICE DEPARTMENT

300 Gardnertown Road, Newburgh, New York 12550

DONALD B. CAMPBELL
CHIEF OF POLICE

Phone: (845) 564-1100
Fax: (845) 564-1870

August 26th 2025

To: Newburgh Town Board

Cc: Charlene Black/Personnel Department

From: Chief Donald B. Campbell

Subject: Full/Part-Time Dispatcher Position

I am requesting authorization to begin the process of interviewing potential candidates for vacant Full and Part-time Dispatcher. These are budgeted positions that have become vacant by recent resignations(3120.5100)

Respectfully submitted,

Donald B. Campbell
Chief of Police

Review Status Report and Budget Status Report for August 2025

#73

Town of Newburgh Recreation Department
PURCHASE & MAINTENANCE PROGRAM
NYS CONTRACT PM 68135

New York State Contract Purchase Pricing:

Toshiba ES 6527ACT (New building)	\$10,463.00
MJ1116 65 Sheet Saddle-Stitch Folding Finisher	\$1,811.00
KN1103 Finisher Guide Rail	\$16.00
Total:	\$12,290.00

Toshiba ES 4525AC (Desmond)	\$5,660.00
MR4010 Dual Scan Document Feeder	\$450.00
KD1073LT 2,000 Sheet Letter Drawer	\$366.00
MJ1114 65 Sheet Saddle-Stitch Folding Finisher	\$1,166.00
KN5005 Bridge Kit	\$53.00
GD1370N Internal Fax	\$293.00
Total:	\$7,988.00

Total for both Systems:	\$20,278.00
-------------------------	-------------

Toshiba Total Quality Maintenance:

5 Year Contract: \$447.35/month (Pooled Contract 2 Systems)

Includes:

- ALL PARTS, MAINTENANCE AND REPAIRS
- ALL SUPPLIES (Except Paper and Staples)
- Includes 3,300 Black Images Per Month (Current Average Usage)
- Includes 11,175 Color Images per Month (Current Average Usage)
- Overages Billed Quarterly At:
\$0.00725 Per Black Image
\$0.03789 Per Color Image

TOSHIBA

TOSHIBA



e-STUDIO™ 6527AC/7527AC

Introducing a new generation of Toshiba departmental MFPs – with high-performance, zero-trust security and cloud-ready features, these printers are the perfect choice for today's modern work environments.

- Highly Productive Color MFPs
- High-speed – 65 & 75 PPM Color and 75 & 85 PPM Black & White
- Leading-edge Security Features
- Cloud Print & Service Capabilities
- Built-in Optical Character Recognition

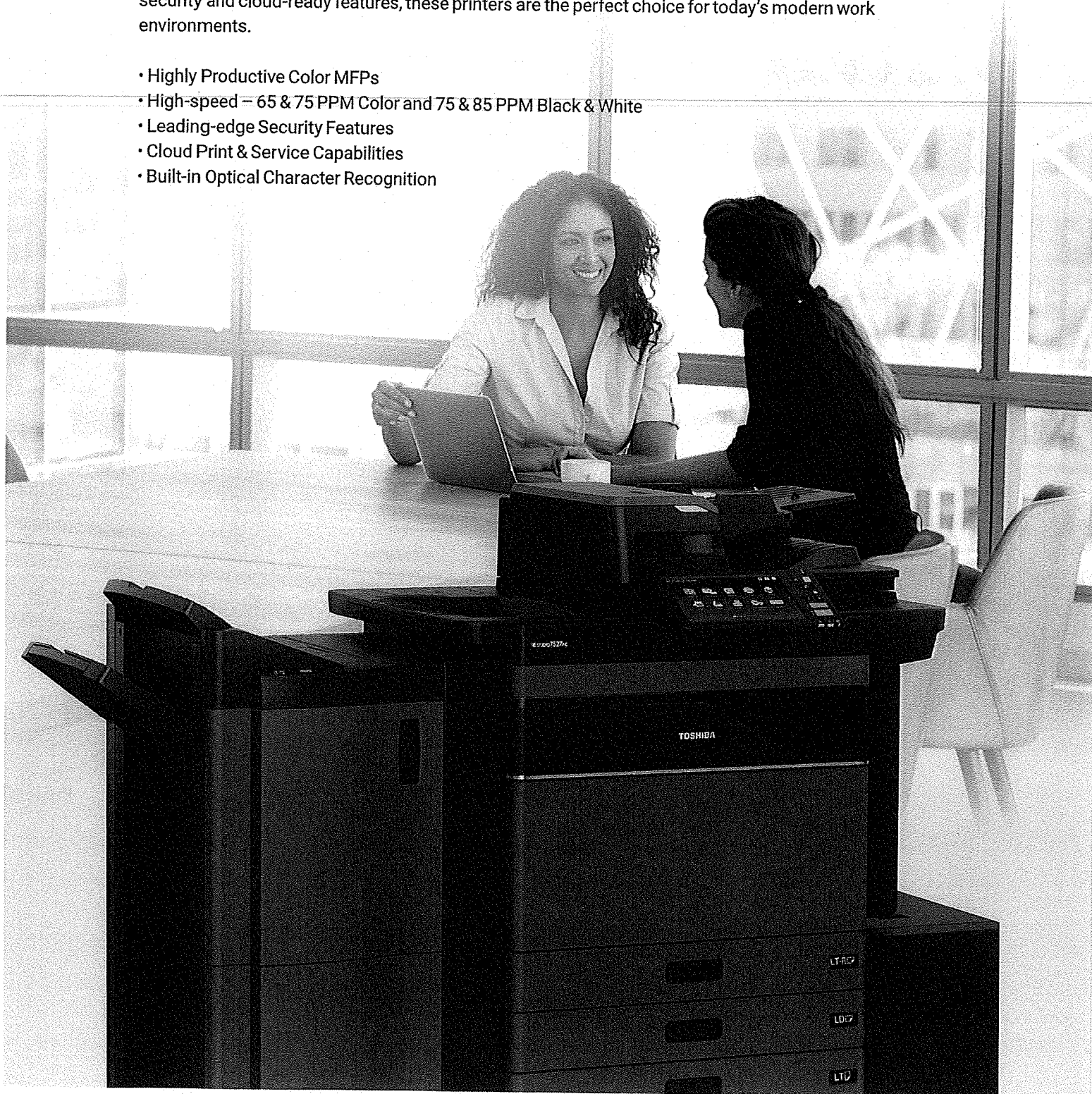

TOSHIBA

CLOUD-READY AND SECURE FOR TODAY'S DIGITAL WORKPLACE

Today's new hybrid work environment demands that information be available and accessible from anywhere at any time for organizations to be efficient and productive. Yet it needs to be secure. Introducing Toshiba's newest e-STUDIO™ departmental MFPs, specifically designed to meet this need. Providing the ultimate in productivity through speed, quality and consistency, these printers also deliver a zero-trust approach for the highest level of security and cloud-ready features built-in for anywhere accessibility.

AT TOSHIBA, PRODUCTIVITY IS A PRIORITY

Our new color MFPs are faster and more productive, secure, and reliable than any other departmental models Toshiba has ever produced. With everything from a super-charged document feeder with Double Feed Detection to greater maximum paper capacity to next-level finishing performance, these new models raise the bar on what an MFP can do for productivity in the modern workplace.

65 & 75 PPM Color and 75 & 85 PPM Black & White to serve the needs of busy departmental environments.

New High-Speed, High-Capacity Dual Scan Document Feeder (DSDF) with Double Feed Detection (DFD) for the most mission-critical scanning environments, providing up to 240 IPM duplex scan speeds.

High-Resolution for crisp image quality: up to 1,200 dpi x 1,200 dpi.

Accurate Color & e-BRIDGE® Color Profiler Tool V4.1 allows demanding color print users to accurately hit the widest array of recognized Pantone colors or unique brand identity colors or match other output devices too.

65-Sheet Stapling takes finishing to the next level and is available on both the regular and saddle stitch finisher, the latter capable of producing booklets up to 60-pages.



Integral Tandem LCF or four-drawer base units allows users to address their volume or versatility demands with up to an 8,020-sheet maximum paper capacity or up to seven separate paper sources by adding a 2,500 sheet letter-size external LCF and even a unique 2,000-sheet piggyback LCF to that for the most volume-intensive environments.

10.1" Tablet-Style Full Color Tilting Touch Screen Panel offers touch swipe User Interface (UI) featuring newly designed icons that provide access to the MFP's core functions and productivity-enhancing workflow solutions – all while offering a consistent and familiar user experience to the entire Office Collection.



Built-in OCR (Optical Character Recognition) allows you to quickly and easily scan paper documents to create searchable PDFs or editable document formats, such as Microsoft® Word®.

Motion Sensor wakes up the MFP as you approach, bringing it to a ready state without any other action.

Voice Guidance Technology affirms your programming selections and is a great option for users with visual disabilities through Section 508 of the Rehabilitation Act, opening it up to a wider audience.

Soft Closing Drawers provide a luxurious feeling and better end user experience.

Environmentally Friendly is the Toshiba way: RoHS compliant, recycled plastics, Low-Power (1W) Super Sleep Mode, and our EcoSmart Recycling Program – as well as lower TEC values for more energy efficiency, earning them the newest EPA ENERGY STAR 3.1 rating.

Higher Duty Cycles and Periodic Maintenance Intervals provide greater volume with fewer routine service calls so you can stay focused on productivity.



Optical Character
Recognition



Motion
Sensor



Voice
Guidance

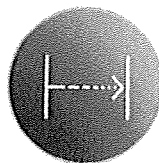

Soft Close
Drawers



Environmentally
Friendly

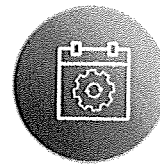

Fewer Routine
Service Calls

SECURITY IS JOB NUMBER ONE

secureMFP

Security has never been a more critical consideration for any device in today's business landscape. MFPs have the extra burden of being shared by all users, and many if not all written documents pass through this device while being printed, scanned, faxed, or copied. That's why Toshiba strongly believes in zero-trust security principles while designing the applications and cloud services for MFPs. Instead of assuming that the applications and services running on MFPs behind the corporate firewall are safe, we ensure that access and communication is fully authenticated, authorized, and encrypted. We accomplish this by enhancing security using the following features:

Trusted Platform Module 2.0 features the latest version of hardware-based security that safeguards all data on the MFP using cryptographic keys.

Built-in Antimalware that's stronger than antivirus protects the MFP from Trojan horses, ransomware, spyware, rogue software, and more.

OAuth2 Token-based Identity Management helps integrate cloud services with your existing identity management, therefore credentials are not replicated, and the chance of vulnerabilities is reduced.

Enhanced Data Encryption with TLS 1.3 keeps the communication between MFP and other applications fully secure thanks to the latest and most secure version of transport layer security.

New 128GB SSD provides the latest encryption and improved reliability.

512GB SSD option provides additional onboard document storage capacity.

FIPS 140-2 Validated HDD option enables these MFPs to meet the Hardcopy Device Protection Profile (HCD-PP) when the MFP is configured in High Security Mode.

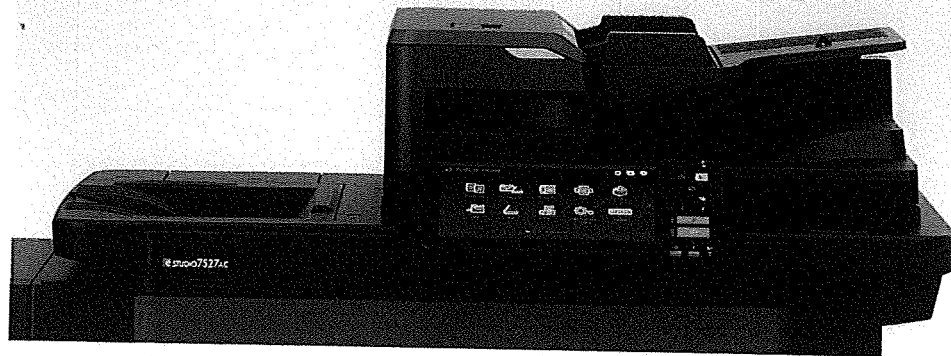

e-STUDIO™ 6527AC/7527AC

HARNESS THE POWER OF THE CLOUD

With **Elevate Sky™** from Toshiba, you'll find cloud-based print solutions for the modern workforce, allowing workflows to seamlessly integrate your MFPs and documents with the cloud applications you're already using.

e-BRIDGE® Global Print allows you to fully embrace cloud technology. It simplifies and secures your print environment while providing the flexibility for users to print from anywhere – work, home office, or on the road.

Elevate Sky™ Services from Toshiba is a suite of cloud-based applications designed to better manage print and document environments by improving device uptime and visibility to fleet usage and performance.

Leveraging big data analytics and artificial intelligence, **Elevate Sky™ Service** can identify impending errors before they happen. In many cases, remote intervention can address the issue before affecting regular device operations.

Elevate Sky™ MFPCoconnect is an innovative and exclusive, cloud-based app that's ideal for remote fleet management, application and license deployment, and policy-based security management for your fleet.

Elevate Sky™ Remote Assist enables technicians, with the end-user's approval, to remotely access the MFP and perform diagnostics and adjustments potentially eliminating the need for what might otherwise be an onsite service call.

Elevate Sky™ Predict assists technicians by applying predictive analytics to anticipate an MFP's service needs thus improving uptime.

Elevate Sky™ AI uses machine learning models to predict parts failures within a Toshiba fleet, helping reduce service costs by optimizing technician dispatch.

Elevate Sky™ Manage allows IT administrators to remotely monitor fleet status, deploy licenses and applications to devices, and ensure that all Toshiba MFPs on the network have consistent and compliant security settings and policies.

Elevate Sky™ Reports monitors MFP usage patterns, generate, and schedule custom reports for their entire fleet to gain valuable insights into how MFPs are being utilized.

Toshiba's cloud-ready MFPs and our team of experts provide the solutions your business needs to improve workflows and print smarter. Utilizing the latest technological advancements and security standards, we provide end-to-end solutions to help you seamlessly and securely navigate today's digital workplace from consulting, cloud migration, fleet management, implementation, and technical support.



THE ULTIMATE IN PRODUCTIVITY

e-STUDIO™ 6527AC/7527AC

- 1 **Dual Scan Document Feeder** with Double Feed Detection – Scans up to 240 IPM; holds up to 300 originals (refillable)
- 2 **10.1" Tiltable Front Panel** makes programming jobs easier than ever – even for wheelchair users – and is Section 508 friendly
- 3 **Optical Sensor** detects when users approach to ensure it's ready when they arrive
- 4 **65-Sheet Stapling Finishers** and an output capacity of up to 3,000 pages enable bigger jobs
- 5 **Saddle Stitch Finishing** enables up to 60-page booklets, and unique avalanche tray increases exit capacity
- 6 **Soft Closing Drawers** automatically pull drawer closed when initiated and provide a luxury experience
- 7 **Four-Drawer or Integral Tandem** base unit design addresses versatility and volume demands
- 8 **2,500-Sheet External LCF** meets the needs of busy departmental color settings
- 9 **Unique Piggyback LCF** raises capacity to potentially over 8,000 sheets for the most demanding environments



MAIN SPECIFICATIONS

Copy System	Indirect Electrostatic Photographic/OPC/Laser Printing/Heat Roller Fusing
Display	10.1" Color WSVGA Touch Screen Tilting Display
Copy Speed	Color: 65/75 PPM (LT), Monochrome: 75/85 PPM (LT)
First Copy Out	Color: 6.4/5.4, Monochrome: 4.5/4.1 Seconds
Warm-Up Time	From Powering On: Approx. 20 Seconds
	From Sleep & Low Power: Less Than 15.4 Seconds
Copy Resolution	600 x 600 dpi
Stack Feed Bypass	3.9" x 5.8" to 12" x 18", 12" x 47" Banner, Envelope
Multiple Copying	Up to 999 Copies
Paper Capacity	Four Drawer Version: Standard 2,280 Sheets/Max. 6,780 Sheets Tandem Drawer Version: Standard 3,520 Sheets/Max. 8,020 Sheets
	300-Sheet DSDf with Double Feed Detection
Original Feed	LD/A3
Max. Original Size	Drawers: 540 Sheets-ST-R to 12" x 18"
Paper Feed Sizes	Integral Tandem LCF: 1,160 x 2 LT Only Stack Feed Bypass: 120 Sheets-3.9" x 5.8" to 13" x 19", 12" x 47" Banner Opt. 2,500-Sheet External LCF LT Only Opt. 2,000-Sheet Piggyback External LCF LT Only Drawers: Standard: 540 Sheets x 4-16lb Bond-110lb Cover Tandem LCF 1,160 Sheets x 2-16lb Bond-110lb Cover Plus 540 Sheets x 2-16lb Bond-110lb Cover Stack Feed Bypass: 120 Sheets-16lb Bond-110lb Cover Opt. 2,500-Sheet External LCF LT Only-16lb Bond-110lb Cover Opt. 2,000-Sheet Piggyback External LCF LT Only-16lb Bond-110lb Cover Standard Automatic Duplex Unit (16lb Bond-140lb Index)
Duplex	25% to 400%
Reproduction Ratio	540K/600K Month (Color: 100%)
Max Duty Cycle	Approx. 470lb
Weight	37.6" (W) x 27.5" (D) x 48.3" (H)
Approx. Dimensions	CMY: 39,200, K: 106,600 @ 5%
CMYK Toner Yield	120 Volts, 50/60 Hz, 16 Amps
Power Source	Maximum 2.0kW/2.4kW (120V)
Power Consumption	NEMA 5-20
Plug Type	6GB
Memory	128GB Solid State Drive (SSD)
Hard Disk Drive	

e-BRIDGE NEXT PRINT SPECIFICATIONS

PDL	PCL5e, PCL5c, PCL6 (PCL XL), PS3, PDF, XPS, JPEG
Print Resolution	600 x 600 dpi, 1,200 x 1,200 dpi or 3,600 (Equivalence) x 1,200 dpi (BW/with Smoothing) (PS3 Only)
Operating Systems	Windows® 8.1, 10, 11, Windows Server® 2012/R2, Windows Server® 2016/19/22, Macintosh® (macOS X 10.10-15, 12), Unix®, Linux®
Network Protocols	TCP/IP (IPv4, IPv6), NetBIOS over TCP/IP, IPX/SPX® for Novell® Environments, EtherTalk for Macintosh Environments
Printing Protocols	SMB V1-3, LPR/LPD, IPP V1.2 w/Authentication (TLS 1.2/1.3), AppleTalk® PAP or EtherTalk, Port 9100 (Bi-Directional), NetWare P-SERVER LPD w/Print, Bluetooth (HCRP/BIOP/PP/FTP), WS Print, FTP
Print Drivers	Windows® 8.1 (32-bit, 64-bit), Windows Server® 2012/R2 (64-bit), Windows Server® 2016/19/22, Windows® 10, 11 (64-bit), macOS X 10.12-15, 11, 12
Interface	RJ-45 Ethernet (10/100/1000 Base-T), USB 2.0 (High-Speed)
Wireless Device	Optional IEEE802.11b/g/n, Wireless LAN, Optional Bluetooth AirPrint®, Mopria®, e-BRIDGE Print & Capture Application on iOS and Android (Available via Apple® App Store or Google Play)
Device Management	TopAccess
Account Control	Up to 10,000 Users or 1,000 Departments Supports User Authentication (on Device), Login Name/Password (via Windows® Domain) or Login Name/Password (via LDAP Server) for Copy, Print, Scan, Fax, List, and User Function
Accessibility Features	Tilt Front Panel, Job Programs, Universal Grip for Paper Trays, Disable Screen Timeout, Audible Beeps, Optional Voice Assist

Security Features

User Authentication, Trusted Platform Module, On-Board Data
Scramble Function, SCEP, Disable, e-Filing, Disable Copy, Disk
Overwrite*, IP Address Filtering (10 Sets), MAC Address Filtering (10
Sets), Network Service Control, Network Port Control, SMB Packet
Signing, SSL/TLS (HTTP, IPP, LDAP, SMTP, POP, FTP, DPWS,
SYSLOG), IPsec (IKEv1, IKEv2), Security Mode Change, CC Certified
(ISO/IEC15408)* with HCD-PP v1.0, IEEE802.1X (Wired/Wireless),
Digital Signature for Client Utilities, Password Policy, Password Lock,
Password Expiration, Self Testing, Job Access Control, Log Access
Control for Job Log, Security Stamp, Role Based Access Control,
Secure PDF, Digital Signature for Firmware Update, Integrity Check
Function, Image Log, Card Authentication, Biometric Authentication
*Conformance with HCD-PPv1.0 in High Security Mode
ENERGY STAR® (V3.1), EPEAT Gold, Californian Proposition 65
WHQL (Windows® 8, 8.1, 10, 11, 2012, 2012 R2, 2016/19/22), Novell®,
Citrix®, SAP, AirPrint® and Mopria®

Environmental Standards Certifications

SCAN SPECIFICATIONS

Scan Speed	DSDf Scan: Up to 240 IPM Duplex, 120 IPM Simplex (Monochrome or Color)
Scan Weights	9.3-110lb Bond
Scan Modes	RADF Scan: Simplex: 9.3-41.8lb Bond, Duplex: 13.3-41.8lb Bond
OCR	Standard: Full Color, Auto Color, Monochrome, Grayscale
Scan Resolution	DOC/XLS/PPT/PDF
File Formats	600 dpi, 400 dpi, 300 dpi, 200 dpi, 150 dpi, 100 dpi Monochrome: TIFF-Multi/Single Page, PDF-Multi/Single Page, PDF/A, Searchable PDF, XPS-Multi/Single Page, DOCX, XLSX, PPTX Color/Grayscale: JPEG, TIFF-Multi/Single Page, PDF-Multi/Single Page, PDF/A, Slim PDF, Searchable PDF, XPS-Multi/Single Page, DOCX, XLSX, PPTX
Image Compression	Color/Grayscale: JPEG (High, Middle, Low)

FACSIMILE SPECIFICATIONS

Compatibility	Super G3
Data Compression	MH/MR/MMR/JBIG
Transmission Speed	Approx. 3 Seconds Per Page
Fax Modem Speed	Up to 33.6 Kbps
Memory Transmission	100 Jobs (with HDD), 2,000 Destinations Max. 400 Destinations/Job
Scan Speed	0.7 Seconds Per Page, Maximum 73 IPM

e-FILING SPECIFICATIONS

Operation Method	Color Touch Screen Control Panel or Client PC
Number of Boxes	1 Public Box, 200 Private User Boxes
Capacity of Boxes	100 Folders Per Box, 400 Documents Per Folder/Box, 200 Pages Per Document

ACCESSORIES (OPTIONS)

Additional Paper Options		Software Options	
Large Capacity Feeder - 2,500 Sheet	MP2503L	e-BRIDGE Global Print	GB2550NODE
Large Capacity Feeder - 2,000 Sheet	MP2002L	IPSec Enabler	GP1080NODE
LCF Connector (to Add 2K LCF)	KN9000	Unicode Font Enabler	GS1007NODE
Finishing Options		Multi-Station Print Enabler	
65-Sheet Staple Finisher	MJ1115	Per Seat License	GS1090NODE
65-Sheet Saddle-Stitch Finisher	MJ1116	e-BRIDGE Plus for OneDrive	
Hole Punch for MJ1115/MJ1116	MJ6108N	for Business V3.0	GB2300NODE
Exit Tray	K6551	e-BRIDGE Plus for SharePoint	
Connectivity/Security Options		Online V3.0	GB2310NODE
FAX Unit/2nd Line for FAX Unit	GD1370N	e-BRIDGE Plus for Exchange	
Wireless LAN/Bluetooth	GN4030A3	Online V3.0	GB2320NODE
Fax Over IP License Key	GS1100NODE	Workplace Productivity Bundle	GB2330NODE
Bluetooth Keyboard	GR9001	e-BRIDGE Plus for Gmail	GB2380NODE
2nd NIC Holder	GR1430	e-BRIDGE Plus for Google	
USB Hub	GR1420	Workspace	GB2390NODE
Meta Scan Enabler	GS1010NODE	e-BRIDGE Plus Voice Guidance	GB2540NODE
Security SSD (512GB)	GE1280		
FIPS HDD (320GB)	GE1260		
Miscellaneous Options			
Card Reader Holder	GR1320		
Accessory Tray	GR1330		
Panel 10-Key Option	GR1340		
Manual Pocket	KK5008		
Harness for Coin Controller	GQ1280		
Accessible Arm	KK2560		



Designs and specifications subject to change without notice. Specifications may vary by conditions of use and/or environmental usage. For best results and reliable performance, always use supplies manufactured or designated by Toshiba. Not all options and accessories may be available at the time of product launch. Please contact a local Authorized Toshiba Dealership for availability. Toner yields are estimates based on 5% coverage, letter-size page. Driver and connectivity feature support varies by client/network operating system. Product names may be trademarks of their respective companies. AirPrint® and the AirPrint® logo are trademarks of Apple Inc. This is a Class 1 laser product complying with IEC60825-1. All company and/or product names are trademarks and/or registered trademarks of their respective manufacturers in their markets and/or countries.

Corporate Office

25530 Commercentre Drive, Lake Forest, CA 92630
Tel: 949-462-6000

East Coast

959 Route 46 East, 5th Floor, Parsippany, NJ 07054
Tel: 973-316-2700

Midwest

8770 W. Bryn Mawr Ave., Suite 700, Chicago, IL 60631
Tel: 773-380-6000

South

2037 Bakers Mill Rd., Dacula, GA 30019
Tel: 678-546-9385

West Coast

25530 Commercentre Drive, Lake Forest, CA 92630
Tel: 949-462-6000

Website

business.toshiba.com

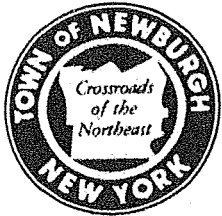

TOWN OF NEWBURGH

~~NEWBURGH~~
#7C

1496 Route 300, Newburgh, New York 12550

PERSONNEL DEPT.

PH: 845-566-7785
Fax: 845-564-2170

To: Supervisor Piaquadio
Town Board Members

From: Eileen P Rose, HR Manager *EPR*

Date: September 3, 2025

Re: Recreation Aide Position

Please see attached the recommendation from James Presutti, Commissioner, to fill the position of Recreation Aide. Joseph Finch showed an interest in the full-time position. Currently is a part-time laborer in the Recreation Department. He would need to complete full-time paperwork only. The full-time date will be on or after September 15, 2025, he has been pre-approved from Orange County Human Resources. His salary will be \$21.4208 per hour per the CSEA contract Step 5.

Thank you in advance.

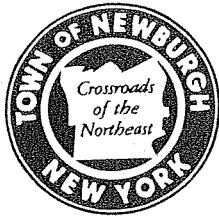

TOWN OF NEWBURGH RECREATION DEPARTMENT

311 ROUTE 32, NEWBURGH, NY 12550

Jim Presutti

Commissioner of Parks, Recreation & Conservation

845-564-7815

FAX: 845-564-7827

TO: Gil Piaquadio, Supervisor
Town Board Members

CC: Charlene Black, Personnel

FROM: Jim Presutti, Commissioner

DATE: August 26, 2025

RE: Request to Hire Full Time Recreation Aide

We are requesting your approval to hire Joseph Finch as a Full Time Recreation Aide. Mr. Finch will be hired at the rate of \$21.4208/hour.

This position is currently funded in the 2025 Recreation Department budget. The start date for this position will be on or after September 15th.

Thank you for your consideration.

Regards,

Jim Presutti
Commissioner

TOWN OF NEWBURGH

EMPLOYMENT REQUEST FORM

To: Personnel Department

NAME OF CANDIDATE: JOSEPH FINCH

DEPARTMENT: RECREATION

TITLE OF POSITION: RECREATION AIDE

FULL TIME OR PART TIME: FULL TIME

HOURLY RATE: \$21.4208

IS POSITION FUNDED IN CURRENT BUDGET: ☒ YES OR NO ☐

FUND APPROPRIATION NUMBER: A7310.5100

PROPOSED HIRE DATE: ON OR AFTER 9/15/25

NOTE: CANDIDATE CANNOT BEGIN WORK WITHOUT PRE-EMPLOYMENT PHYSICAL AND COMPLETION OF ALL REQUIRED PAPERWORK.

DEPARTMENT HEAD SIGNATURE

8/26/25
DATE

ORIGINAL APPLICATION SHOULD BE ON FILE IN THE PERSONNEL
DEPARTMENT

COPY TO ACCOUNTING DEPARTMENT
5-22-2017



#8A

TOWN OF NEWBURGH ANIMAL CONTROL & SHELTER

645 GIDNEY AVE. NEWBURGH, NY 12550

TEL: (845)561-3344

FAX: (845) 561-2220

To: Town Board

From: Tracey Carvell, Animal Control

Subject: Authorization to pay Vet Services Utilizing Account 5144

Date: 8-27-25

I am requesting authorization to pay for Vet service:

N.V.H.

*Totaling: \$ 1,947.41

Canine: \$ 772.13

Feline: \$ 1175.48

Other: \$

TOWN OF NEWBURGH

1496 Route 300

Newburgh, New York 12550

(845) 564-4552

DEPARTMENT

Animal Control

CLAIMANT'S

NAME

AND

ADDRESS

Newburgh Veterinary Hospital
1716 Route 300
Newburgh, NY 12550
(845) 564-2660

TERMS

Net 30 Days

DO NOT WRITE IN THIS BOX

Date Voucher Received

FUND - APPROPRIATION

AMOUNT

VOUCHER NO.

Total

Abstract #

Invoice #

Canine

Dates	Quantity	Description of Materials or Services	Unit Price	Amount
7/29/25	937689			211.50 ✓
7/31/25	937922			17.00 ✓
8/5/25	938439			184.71 ✓
8/16/25	939450			202.57 ✓
8/21/25	939984			156.35 ✓
			TOTAL	772.13

CLAIMANT'S CERTIFICATION

Dora M Cast

certify that the above account is the account of \$

772.13

is true

and confirm that the taxes, services and other charges were rendered to or for the municipality on the dates stated; that no part has been paid or satisfied; that taxes, from which the municipality is exempt, are not included; and that the amount claimed is actually due.

8/26/25

DATE

Dora M Cast

SIGNATURE

Practice Mgr.

TITLE

(Space below for municipal use)

DEPARTMENT APPROVAL

The above services or materials were rendered or furnished to the municipality on the dates stated and the charges are correct.

8/27/25
Date

Authorized Official

APPROVAL FOR PAYMENT

This claim is approved and ordered for paid from the appropriations indicated above

Date

Auditing Board

INVOICE

Newburgh Veterinary Hospital

1716 Route 300
Newburgh, NY 12550
845 564-2660

"Your pet is part of our family too." Visit us at www.newburghvet.com

FOR: Town of Newburgh - canine
645 Gidney Ave
Newburgh, NY 12550
(845) 561-3344

Printed: 08-26-25 at 4:37p
Date: 07-29-25
Account: 19984
Invoice: 937689

Date	For	Qty	Description	Price	Discount	Net Price
07-29-25	39-25 Max	1	Weight Monitoring			0.00
07-29-25		1	Neuter/Canine- Town of Newburgh	140.00	45.00	95.00 **
07-29-25		1	Anesthesia- Isoflurane	454.00	454.00	0.00 **
07-29-25		1	---BloodPressureMonitoring w/anes			0.00
07-29-25		1	---PulseOximeterMonitoring w/Anes			0.00
07-29-25		1	-CapnographMonitoring w/Anesthe			0.00
07-29-25		1	----Recovery in Heated Cage			0.00
07-29-25		1	----Warm Water Blanket in Surgery			0.00
07-29-25		0.20	-HydromorphoneInject 10mg/ml Co			0.00
07-29-25		3.20	Penicillin G Inject / ml (in hosp)	33.52	33.52	0.00 **
07-29-25		2.50	Rimadyl/ Carprofen Inject / ml (in h	90.50	90.50	0.00 **
07-29-25		0.60	-TelazolInject Control Log / ml			0.00
07-29-25		1	PEDICURE- simple	22.00	22.00	0.00 **
07-29-25		1	Elizabethan Collar 30cm	32.50	27.71	4.79 **
07-29-25		1	LYME,HW,EHRlichia,ANAPLAS	127.00	97.00	30.00 **
07-29-25		1	OSHA Compliance Biohazards Fee	12.60	6.30	6.30 **
07-29-25		1	Canine Dist/A2/Parainfluenza/Parvo	64.00	47.00	17.00 **
07-29-25		1	Canine Respiratory Complex- Bord	64.00	47.00	17.00 **
Canine Kennel Cough is A HIGHLY contagious respiratory infection. Dogs can be exposed at any time through coughing or nose to nose contact. Boarding, grooming and or showing dogs can have incresased risk of exposure....please be sure to have your pet boosted every 12 months.						
07-29-25		1	CANINE RABIES / 1YEAR	64.00	46.00	18.00 **
07-29-25		10	Amoxicillin 500mg capsule #39879	24.55	23.73	0.82 **
07-29-25		5	Carprovet Tabs 100mg #398791	23.70	20.99	2.71 **
07-29-25		30	Trazodone 100mg tablets #398792	30.35	28.01	2.34 **
07-29-25		1	Panolog / Animax Ointment 15ml. #	40.47	22.93	17.54 **
07-29-25		1	Veterinarian's Notes			0.00

Total charges, this invoice...

211.50

**Total discount included: 1011.69

Your invoice total reflects our **13Stray Cat Accounts** discount.

COPY

INVOICE

Newburgh Veterinary Hospital

1716 Route 300
Newburgh, NY 12550
845 564-2660

"Your pet is part of our family too." Visit us at www.newburghvet.com

FOR: Town of Newburgh - canine
645 Gidney Ave
Newburgh, NY 12550
(845) 561-3344

Printed: 08-26-25 at 4:36p
Date: 07-31-25
Account: 19984
Invoice: 937922

Date	For	Qty	Description	Price	Discount	Net Price
07-30-25	39-25 Max	1	4DX Elisa Negative			0.00
07-31-25	Smudge 32-25	1	Canine Dist/Aden/Parainfluenza/Pa Your pet has been given the second vaccination in a series that requires revaccination every 3-4 weeks until your puppy is approximately 14-16 weeks of age. Occasionally, loss of appetite, listlessness, or localized discomfort may occur. If there is severe lethargy or facial swelling, call us for advice.	64.00	47.00	17.00 **
07-31-25		1	Recommend-Fecal (please dropoff Annual fecal microscopic exams are very important for the health of your pet and, since some worms are transmissible to humans, for the health of your family. Please bring us your pet's fecal sample at your earliest convenience			0.00
07-31-25		1	Zoonoses Discussed Zoonotic potential of intestinal parasites- in particular roundworms.			0.00
Total charges, this invoice...						17.00
**Total discount included: 47.00						

Your invoice total reflects our **13Stray Cat Accounts** discount.

Reminders for: 39-25 Max (Weight: 64.0 lbs - 4y)		Last done
07/26	Canine Dist/Aden/Parainfluenza	
07/26	lyme,HW,Ehrlichia Accu Plus4(A	07-29-25
07/26	CANINE RABIES / 3 YEAR	
07/26	Canine Kennel Cough Vacc -1 ye	07-29-25
01/26	Neuter your pet at 5-6 months	
01/26	FECAL EXAM	
01/26	FECAL KEYScreens PCR	
07/22	Pro-Heart 12 (51-100lbs)	

COPY

Newburgh Veterinary Hospital

1716 Route 300
Newburgh, NY 12550
845 564-2660

INVOICE

"Your pet is part of our family too." Visit us at www.newburghvet.com

FOR: Town of Newburgh - canine
645 Gidney Ave
Newburgh, NY 12550
(845) 561-3344

Printed: 08-26-25 at 4:36p
Date: 08-05-25
Account: 19984
Invoice: 938439

Date	For	Qty	Description	Price	Discount	Net Price
08-05-25	Linden #40-25	1	Weight Monitoring			0.00
08-05-25		1	Neuter/Canine- Town of Newburgh	140.00	45.00	95.00 **
08-05-25		1	Anesthesia- Isoflurane	454.00	454.00	0.00 **
08-05-25		1	---BloodPressureMonitoring w/anes			0.00
08-05-25		1	---PulseOximeterMonitoring w/Anes			0.00
08-05-25		1	-CapnographMonitoring w/Anesthe			0.00
08-05-25		1	----Recovery in Heated Cage			0.00
08-05-25		1	----Warm Water Blanket in Surgery			0.00
08-05-25		0.15	-HydromorphoneInject 10mg/ml Co			0.00
08-05-25		2.50	Penicillin G Inject / ml (in hosp)	32.75	32.75	0.00 **
08-05-25		1	Oral, Topical medication administr	12.60	12.60	0.00 **
08-05-25		0.50	-TelazolInject Control Log / ml			0.00
08-05-25		1	PEDICURE- simple	22.00	22.00	0.00 **
08-05-25		1	Elizabethan Collar 25cm	32.50	28.70	3.80 **
08-05-25		1	OSHA Compliance Biohazards Fee	12.60	6.30	6.30 **
08-05-25		1	Canine Dist/A2/Parainfluenza/Parvo	64.00	47.00	17.00 **
08-05-25		1	Canine Respiratory Complex- Bord	64.00	47.00	17.00 **
Canine Kennel Cough is A HIGHLY contagious respiratory infection. Dogs can be exposed at any time through coughing or nose to nose contact. Boarding, grooming and or showing dogs can have incresased risk of exposure....please be sure to have your pet boosted every 12 months.						
08-05-25		1	CANINE RABIES / 1YEAR	64.00	46.00	18.00 **
08-05-25		1	LYME,HW,EHRlichia,ANAPLAS	127.00	111.40	15.60 **
08-05-25		1	OSHA Compliance Biohazards Fee	12.60	6.30	6.30 **
08-05-25		10	Amoxicillin 250mg capsule #39923	21.75	21.09	0.66 **
08-05-25		5	Carprovet Tabs 100mg #399240	23.70	20.99	2.71 **
08-05-25		30	Trazodone 100mg tablets #399241	30.35	28.01	2.34 **
08-05-25		1	Veterinarian's Notes			0.00

Total charges, this invoice...

184.71

**Total discount included: 929.14

Your invoice total reflects our **13Stray Cat Accounts** discount.

COPY

Newburgh Veterinary Hospital

1716 Route 300
Newburgh, NY 12550
845 564-2660

INVOICE

"Your pet is part of our family too." Visit us at www.newburghvet.com

FOR: Town of Newburgh - canine
645 Gidney Ave
Newburgh, NY 12550
(845) 561-3344

Printed: 08-26-25 at 4:35p
Date: 08-16-25
Account: 19984
Invoice: 939450

Date	For	Qty	Description	Price	Discount	Net Price
08-13-25	Ollie	1	Neuter/Canine <1YR	456.00	361.00	95.00 **
08-13-25		1	-Isoflurane Gas Anesthesia			0.00
08-13-25		1	---PulseOximeterMonitoring w/Anes			0.00
08-13-25		1	-CapnographMonitoring w/Anesthe			0.00
08-13-25		1	-----Recovery in Heated Cage			0.00
08-13-25		0.10	-HydromorphoneInject 10mg/ml Co			0.00
08-13-25		1.75	Penicillin G Inject / ml Outpatient	31.68	31.68	0.00 **
08-13-25		1.40	Rimadyl/ Caprofen Inject / ml Outpa	49.79	49.79	0.00 **
08-13-25		0.40	-TelazolInject Control Log / ml			0.00
08-13-25		1	PEDICURE- simple	22.00	22.00	0.00 **
08-13-25		1	LYME,HW,EHRLICHIA,ANAPLAS	127.00	97.00	30.00 **
08-13-25		1	Elizabethan Collar 25cm	32.50	28.70	3.80 **
08-13-25		1	Canine Respiratory Complex- Bord	64.00	47.00	17.00 **
Canine Kennel Cough is A HIGHLY contagious respiratory infection. Dogs can be exposed at any time through coughing or nose to nose contact. Boarding, grooming and or showing dogs can have incresased risk of exposure....please be sure to have your pet boosted every 12 months.						
08-13-25		1	Canine Dist/A2/Parainfluenza/Parvo	64.00	47.00	17.00 **
08-13-25		1	CANINE RABIES / 1YEAR	64.00	46.00	18.00 **
08-13-25		10	Amoxicillin 250mg capsule #39980	21.75	21.09	0.66 **
08-13-25		5	Carprovet Tabs 75mg #399803	24.35	21.24	3.11 **
08-14-25		1	4DX Elisa Negative			0.00
08-14-25	Rocco 44-25	1	CANINE RABIES / 1YEAR	64.00	46.00	18.00 **
Total charges, this invoice...						202.57
**Total discount included: 818.50						

Your invoice total reflects our **13Stray Cat Accounts** discount.

LIKE US ON FACEBOOK.COM!

GOING AWAY?....BOOK YOUR PETS BOARDING RESERVATION TODAY!

COPY

INVOICE

Newburgh Veterinary Hospital

1716 Route 300
Newburgh, NY 12550
845 564-2660

"Your pet is part of our family too." Visit us at www.newburghvet.com

FOR: Town of Newburgh - canine
645 Gidney Ave
Newburgh, NY 12550
(845) 561-3344

Printed: 08-26-25 at 4:20p
Date: 08-21-25
Account: 19984
Invoice: 939984

Date	For	Qty	Description	Price	Discount	Net Price
08-21-25	Smudge 32-25	1	Neuter/Canine <1YR	456.00	361.00	95.00 **
08-21-25		1	-Isoflurane Gas Anesthesia			0.00
08-21-25		1	---PulseOximeterMonitoring w/Anes			0.00
08-21-25		1	-CapnographMonitoring w/Anesthe			0.00
08-21-25		1	-----Recovery in Heated Cage			0.00
08-21-25		0.05	-HydromorphoneInject 10mg/ml Co			0.00
08-21-25		1	Penicillin G Inject / ml Outpatient	30.96	30.96	0.00 **
08-21-25		0.40	Rimadyl/ Caprofen Inject / ml Outpa	28.19	28.19	0.00 **
08-21-25		0.20	-TelazolInject Control Log / ml			0.00
08-21-25		1	PEDICURE- simple	22.00	22.00	0.00 **
08-21-25		1	Elizabethan Collar 20cm	32.50	29.22	3.28 **
08-21-25		1	CANINE RABIES / 1YEAR	64.00	46.00	18.00 **
08-21-25		1	Canine Respiratory Complex- Bord	64.00	47.00	17.00 **
Canine Kennel Cough is A HIGHLY contagious respiratory infection. Dogs can be exposed at any time through coughing or nose to nose contact. Boarding, grooming and or showing dogs can have incresased risk of exposure....please be sure to have your pet boosted every 12 months.						
08-21-25		1	Canine Dist/A2/Parainfluenza/Parvo	64.00	47.00	17.00 **
08-21-25		10	Amoxicillin 100mg tab #400320	26.15	21.87	4.28 **
08-21-25		5	Carprovet Tabs 25mg #400321	22.25	20.46	1.79 **

Total charges, this invoice...

156.35

**Total discount included: 653.70

Your invoice total reflects our **13Stray Cat Accounts** discount.

Reminders for: **Smudge 32-25** (Weight: 11.0 lbs - 5m) Last done

08/26	CANINE RABIES / 3 YEAR	
08/26	Canine Dist/Aden/Parainfluenza	
08/26	Canine Kennel Cough Vacc -1 ye	08-21-25
03/26	Pro-Heart 12 (51-100lbs)	
12/25	FECAL KEYSCREEN PCR	

COPY

TOWN OF NEWBURGH

1496 Route 300

Newburgh, New York 12550

(845) 564-4552

DEPARTMENT

Animal Control

CLAIMANT'S

NAME

Newburgh Veterinary Hospital

AND

ADDRESS

1716 Route 300

Newburgh, NY 12550

(845)564-2660

DO NOT WRITE IN THIS BOX

Date Voucher Received		VOUCHER NO.
FUND - APPROPRIATION	AMOUNT	
Total		
Abstract #		

TERMS

Net 30 Days

Invoice #

Feline - Page 1 of 2

Dates	Quantity	Description of Materials or Services	Unit Price	Amount
7/25/25	937255			349.0
7/27/25	937504			154.60
7/29/25	937639			126.00
7/30/25	937821			72.00
7/30/25	937882			27.75
7/30/25	937856			20.00
8/2/25	938102			2.40
8/2/25	938132			170.80
8/7/25	938569			17.00
8/9/25	938819			24.84
8/16/25	939406			8520
8/30/25	939839			3.84
			TOTAL	

CLAIMANT'S CERTIFICATION

See next page

I, _____, certify that the above account in the amount of \$ _____ is true and correct; that the items, services and disbursements charged were rendered to or for the municipality on the dates stated; that no part has been paid or received; that taxes, from which the municipality is exempt, are not included; and that the amount claimed is actually due.

DATE

SIGNATURE

TITLE

(Space below for municipal use)

DEPARTMENT APPROVAL

The above services or materials were rendered or furnished to the municipality on the dates stated and the charges are correct.

8/27/25
Date

Authorized Official

APPROVAL FOR PAYMENT

This claim is approved and ordered for paid from the appropriations indicated above

Date

Auditing Board

TOWN OF NEWBURGH

1496 Route 300

Newburgh, New York 12550

(845) 564-4552

DEPARTMENT

Animal Control

CLAIMANT'S

NAME

AND

ADDRESS

Newburgh Veterinary Hospital
1716 Route 300
Newburgh, NY 12550
(845) 564-2660

TERMS

Net 30 Days

DO NOT WRITE IN THIS BOX

Date Voucher Received

FUND - APPROPRIATION

AMOUNT

VOUCHER NO.

Total

Abstract #

Invoice #

Feline - Page 2 of 2

Dates	Quantity	Description of Materials or Services	Unit Price	Amount
8/20/25	939841			17.00
8/22/25	940034			17.00
8/23/25	940180			401.55
			TOTAL	1175.48

CLAIMANT'S CERTIFICATION

Dora M Cast

certify that the above account is the amount of \$

1175.48

is true

and correct; that the name, services and descriptions charged were rendered to or for the municipality on the dates stated; that no part has been paid or received; that taxes, from which the municipality is exempt, are not included; and that the amount claimed is actually due.

8/26/25

DATE

Dora M Cast

SIGNATURE

Practice Mgr

TITLE

(Space below for municipal use)

DEPARTMENT APPROVAL

The above services or materials were rendered or furnished to the municipality on the dates stated and the charges are correct.

8/27/25

Date

Authorized Official

APPROVAL FOR PAYMENT

This claim is approved and ordered for paid from the appropriations indicated above

Date

Auditing Board

INVOICE

Newburgh Veterinary Hospital

1716 Route 300
Newburgh, NY 12550
845 564-2660

"Your pet is part of our family too." Visit us at www.newburghvet.com

FOR: Town of Newburgh - Feline
645 Gidney Ave.
Newburgh, NY 12550
(845) 561-3344

Printed: 08-26-25 at 4:12p
Date: 07-25-25
Account: 4417
Invoice: 937255

Date	For	Qty	Description	Price	Discount	Net Price
07-25-25	Brassy 12k25	1	Weight Monitoring			0.00
07-22-25	Sebastian	1	CONSULT / EXAM - Followup	55.50	27.75	27.75 **
07-22-25		1	Pet Insurance Review			0.00
Please visit www.petinsurancereview.com and dogtime.com for an independent review of all national pet health insurance plans						
07-24-25		1	Bene-Bac Lactobacillus #398417	18.80	11.65	7.15 **
Total charges, this invoice...						34.90
**Total discount included: 39.40						

Your invoice total reflects our **13Stray Cat Accounts** discount.

Reminders for: Brassy 12k25 (Weight: 4.3 lbs - 5m)		Last done
07/26	Rabies/Purevax Feline 1yr	07-30-25
07/26	Feline Rhino/Panleuk/Calici I/	
05/26	CONSULT / EXAM - Annual Wellne	05-09-25
11/25	FECAL KEYSCREEN PCR	
09/25	FECAL EXAM	

Brassy 12k25's weight history (in lbs)

07-25-25	4.30
06-13-25	3.20

LIKE US ON FACEBOOK.COM!

GOING AWAY?....BOOK YOUR PETS BOARDING RESERVATION TODAY!

In compliance with New York State law, all medications are non-refundable. We regret any inconveniences.

COPY

INVOICE

Newburgh Veterinary Hospital

1716 Route 300
Newburgh, NY 12550
845 564-2660

"Your pet is part of our family too." Visit us at www.newburghvet.com

FOR: Town of Newburgh - Feline
645 Gidney Ave.
Newburgh, NY 12550
(845) 561-3344

Printed: 08-26-25 at 4:12p
Date: 07-27-25
Account: 4417
Invoice: 937506

Date	For	Qty Description	Price	Discount	Net Price
07-25-25	Brassy 12k25	1 OHE FELINE	437.00	347.00	90.00 **
		Your pet has been spayed. This eliminates the risk of uterine infection and lowers the risk of breast tumors when she gets older. Expect her to be quiet and not as active for a couple of days. Restrict exercise for the next two weeks. This receipt certifies that your pet has been spayed. Please keep this with your pet's health records.			
07-25-25		1 Anesthesia- Isoflurane	454.00	454.00	0.00 **
07-25-25		1 ---BloodPressureMonitoring w/anes			0.00
07-25-25		1 ---PulseOximeterMonitoring w/Anes			0.00
07-25-25		1 -CapnographMonitoring w/Anesthe			0.00
07-25-25		1 ----Recovery in Heated Cage			0.00
07-25-25		1 ----Warm Water Blanket in Surgery			0.00
07-25-25		1 Zorbium 2-6.6# (0.4ml tube)	46.05	46.05	0.00 **
07-25-25		0.20 Penicillin G Inject / ml (in hosp)	30.22	30.22	0.00 **
07-25-25		0.05 -TelazolInject Control Log / ml			0.00
07-25-25		1 PEDICURE- simple	22.00	22.00	0.00 **
07-25-25		1 Elizabethan Collar 10cm	32.50	30.88	1.62 **
07-25-25		1 Amoxicillin Drops 15ml (50mg/ml)	34.83	10.85	23.98 **
07-25-25		1 FELINE RHINO/PANLEUK/CALICI	52.00	35.00	17.00 **
		Your pet has been immunized against feline distemper, rhinotracheitis, and calicivirus. Occasionally listlessness, lethargy, or lack of appetite may occur. If severe listlessness or facial swelling occurs, please call us for advice.			
07-25-25		1 Feline Rabies Vaccine / Purevax 1y	67.00	45.00	22.00 **
		Today, your cat received the most advanced rabies protection available. PUREVAX Rabies vaccine gives your cat protection that is pure, safe and effective without the use of potentially harmful adjuvants.			

Total charges, this invoice...

154.60

**Total discount included: 1021.00

Your invoice total reflects our **13Stray Cat Accounts** discount.

COPY

INVOICE

Newburgh Veterinary Hospital

1716 Route 300
Newburgh, NY 12550
845 564-2660

"Your pet is part of our family too." Visit us at www.newburghvet.com

FOR: Town of Newburgh - Feline
645 Gidney Ave.
Newburgh, NY 12550
(845) 561-3344

Printed: 08-26-25 at 4:12p
Date: 07-29-25
Account: 4417
Invoice: 937639

Date	For	Qty	Description	Price	Discount	Net Price
07-29-25	21c25	1	Shelter euthanasia and body care f			126.00
Total charges, this invoice...						126.00

LIKE US ON FACEBOOK.COM!

GOING AWAY?....BOOK YOUR PETS BOARDING RESERVATION TODAY!

In compliance with New York State law, all medications are non-refundable. We regret any inconveniences.

COPY

INVOICE

Newburgh Veterinary Hospital

1716 Route 300
Newburgh, NY 12550
845 564-2660

"Your pet is part of our family too." Visit us at www.newburghvet.com

FOR: Town of Newburgh - Feline
645 Gidney Ave.
Newburgh, NY 12550
(845) 561-3344

Printed: 08-26-25 at 5:57p
Date: 07-30-25
Account: 4417
Invoice: 937821

Date	For	Qty	Description	Price	Discount	Net Price
07-30-25	13k15 Tigger	1	NEUTER FELINE	168.00	118.00	50.00 **
07-30-25		0.05	-BuprenorphineInject Control 1.0mg			0.00
07-30-25		0.30	Penicillin G Inject / ml Outpatient	30.28	30.28	0.00 **
07-30-25		0.10	-TelazolInject Control Log / ml			0.00
07-30-25		1	PEDICURE- simple	22.00	22.00	0.00 **
07-30-25		1	Feline Rabies Vaccine / Purevax 1y	67.00	45.00	22.00 **

Today, your cat received the most advanced rabies protection available. PUREVAX Rabies vaccine gives your cat protection that is pure, safe and effective without the use of potentially harmful adjuvants.

Total charges, this invoice... 72.00

**Total discount included: 215.28

Your invoice total reflects our **13Stray Cat Accounts** discount.

Reminders for: 13k15 Tigger (Weight: 3.0 lbs - 5m)	Last done
07/26 Rabies/Purevax Feline 1yr	07-30-25
07/26 Feline Rhino/Panleuk/Calici I/	
05/26 CONSULT / EXAM - Annual Wellne	05-09-25
01/26 FECAL KEYSSCREEN PCR	07-13-25
09/25 FECAL EXAM	

Doctor's Instructions

NEUTER FELINE

Your cat has been neutered. Please watch the surgical site for swelling or redness.

13k15 Tigger's weight history (in lbs)

06-04-25	3.00
05-17-25	2.38

COPY

INVOICE

Newburgh Veterinary Hospital

1716 Route 300
Newburgh, NY 12550
845 564-2660

"Your pet is part of our family too." Visit us at www.newburghvet.com

FOR: Town of Newburgh - Feline
645 Gidney Ave.
Newburgh, NY 12550
(845) 561-3344

Printed: 08-26-25 at 4:10p
Date: 07-30-25
Account: 4417
Invoice: 937822

Date	For	Qty	Description	Price	Discount	Net Price
07-30-25	Rebel 19k25	1	CONSULT / EXAM - Followup	55.50	27.75	27.75 **
07-30-25		1	Pet Insurance Review			0.00
Please visit www.petinsurancereview.com and dogtime.com for an independent review of all national pet health insurance plans						

Total charges, this invoice... 27.75

**Total discount included: 27.75

Your invoice total reflects our **13Stray Cat Accounts** discount.

LIKE US ON FACEBOOK.COM!

GOING AWAY?....BOOK YOUR PETS BOARDING RESERVATION TODAY!

In compliance with New York State law, all medications are non-refundable. We regret any inconveniences.

COPY

INVOICE

Newburgh Veterinary Hospital

1716 Route 300
Newburgh, NY 12550
845 564-2660

"Your pet is part of our family too." Visit us at www.newburghvet.com

FOR: Town of Newburgh - Feline
645 Gidney Ave.
Newburgh, NY 12550
(845) 561-3344

Printed: 08-26-25 at 4:10p
Date: 07-30-25
Account: 4417
Invoice: 937856

Date	For	Qty	Description	Price	Discount	Net Price
07-30-25	Rebel 19k25	1	FECAL KEYScreen PCR	84.50	64.50	20.00 **
Total charges, this invoice...						20.00
**Total discount included: 64.50						

Your invoice total reflects our **13Stray Cat Accounts** discount.

LIKE US ON FACEBOOK.COM!

GOING AWAY?....BOOK YOUR PETS BOARDING RESERVATION TODAY!

In compliance with New York State law, all medications are non-refundable. We regret any inconveniences.

copy

INVOICE

Newburgh Veterinary Hospital

1716 Route 300
Newburgh, NY 12550
845 564-2660

"Your pet is part of our family too." Visit us at www.newburghvet.com

FOR: Town of Newburgh - Feline
645 Gidney Ave.
Newburgh, NY 12550
(845) 561-3344

Printed: 08-26-25 at 4:10p
Date: 08-02-25
Account: 4417
Invoice: 938102

Date	For	Qty	Description	Price	Discount	Net Price
07-31-25	Rebel 19k25	12	Panacur Dewormer Liquid / ml #39	27.47	25.07	2.40 **
Total charges, this invoice...						2.40
**Total discount included: 25.07						

Your invoice total reflects our **13Stray Cat Accounts** discount.

LIKE US ON FACEBOOK.COM!

GOING AWAY?....BOOK YOUR PETS BOARDING RESERVATION TODAY!

In compliance with New York State law, all medications are non-refundable. We regret any inconveniences.

COPY

INVOICE

Newburgh Veterinary Hospital

1716 Route 300
Newburgh, NY 12550
845 564-2660

"Your pet is part of our family too." Visit us at www.newburghvet.com

FOR: Town of Newburgh - Feline
645 Gidney Ave.
Newburgh, NY 12550
(845) 561-3344

Printed: 08-26-25 at 4:09p
Date: 08-02-25
Account: 4417
Invoice: 938132

Date	For	Qty	Description	Price	Discount	Net Price
08-02-25	Grey stray 22C-	1	CONSULT / EXAM - Sick	105.00	66.50	38.50 **
08-02-25		1	OSHA Compliance Biohazards Fee	12.60	6.30	6.30 **
08-02-25		1	Shelter euthanasia and body care f			126.00
Total charges, this invoice...						170.80
**Total discount included: 72.80						

Your invoice total reflects our **13Stray Cat Accounts** discount.

LIKE US ON FACEBOOK.COM!

GOING AWAY?....BOOK YOUR PETS BOARDING RESERVATION TODAY!

In compliance with New York State law, all medications are non-refundable. We regret any inconveniences.

copy

INVOICE

Newburgh Veterinary Hospital

1716 Route 300
Newburgh, NY 12550
845 564-2660

"Your pet is part of our family too." Visit us at www.newburghvet.com

FOR: Town of Newburgh - Feline
645 Gidney Ave.
Newburgh, NY 12550
(845) 561-3344

Printed: 08-26-25 at 4:09p
Date: 08-07-25
Account: 4417
Invoice: 938569

Date	For	Qty	Description	Price	Discount	Net Price
08-07-25	Lexus 18k25	1	Feline Rhino/Panleuk/Calicivirus #	52.00	35.00	17.00 **
	Your cat has received the first in a series of immunizations to protect him/her against feline distemper, rhinotracheitis, and calicivirus. It is important to return for a followup booster in 3-4 weeks. Occasionally listlessness, lethargy, or localized discomfort may occur. If there is severe listlessness or facial swelling, please call us for advice.					

Total charges, this invoice...

17.00

**Total discount included: 35.00

Your invoice total reflects our **13Stray Cat Accounts** discount.

LIKE US ON FACEBOOK.COM!

GOING AWAY?....BOOK YOUR PETS BOARDING RESERVATION TODAY!

In compliance with New York State law, all medications are non-refundable. We regret any inconveniences.

COPY

Newburgh Veterinary Hospital

1716 Route 300
Newburgh, NY 12550
845 564-2660

INVOICE

"Your pet is part of our family too." Visit us at www.newburghvet.com

FOR: Town of Newburgh - Feline
645 Gidney Ave.
Newburgh, NY 12550
(845) 561-3344

Printed: 08-26-25 at 4:08p
Date: 08-09-25
Account: 4417
Invoice: 938819

Date	For	Qty	Description	Price	Discount	Net Price
08-08-25	Sebastian	30	Metronidazole Sol 50mg/ml compo	33.65	26.32	7.33 **
08-08-25		30	Enrofloxacin 50mg/ml Susp / ml #3	39.95	22.44	17.51 **
Total charges, this invoice...						24.84
**Total discount included: 48.76						

Your invoice total reflects our **13Stray Cat Accounts** discount.

LIKE US ON FACEBOOK.COM!

GOING AWAY?....BOOK YOUR PETS BOARDING RESERVATION TODAY!

In compliance with New York State law, all medications are non-refundable. We regret any inconveniences.

COPY

INVOICE

Newburgh Veterinary Hospital

1716 Route 300
Newburgh, NY 12550
845 564-2660

"Your pet is part of our family too." Visit us at www.newburghvet.com

FOR: Town of Newburgh - Feline
645 Gidney Ave.
Newburgh, NY 12550
(845) 561-3344

Printed: 08-26-25 at 4:08p
Date: 08-16-25
Account: 4417
Invoice: 939406

Date	For	Qty	Description	Price	Discount	Net Price
08-14-25	Elvis-26k25	1	Feline Rhino/Panleuk/Calicivirus #	52.00	35.00	17.00 **
	Your cat has received the first in a series of immunizations to protect him/her against feline distemper, rhinotracheitis, and calicivirus. It is important to return for a followup booster in 3-4 weeks. Occasionally listlessness, lethargy, or localized discomfort may occur. If there is severe listlessness or facial swelling, please call us for advice.					
08-14-25		1	Recommend-Fecal (please dropoff			0.00
	Annual fecal microscopic exams are very important for the health of your pet and, since some worms are transmissible to humans, for the health of your family. Please bring us your pet's fecal sample at your earliest convenience					
08-14-25		1	Zoonoses			0.00
	Discussed Zoonotic potential of intestinal parasites- in particular roundworms.					
08-14-25		1	FelV/ FIV Elisa SA260	165.00	119.50	45.50 **
08-14-25		1	OSHA Compliance Biohazards Fee	12.60	6.30	6.30 **
08-14-25		1	Weight Monitoring			0.00
08-15-25		1	Feline Leukemia Elisa Negative			0.00
08-15-25		1	FIV Elisa Negative			0.00
08-14-25	Priscilla 27k25	1	Feline Rhino/Panleuk/Calicivirus #	52.00	35.00	17.00 **
	Your cat has received the first in a series of immunizations to protect him/her against feline distemper, rhinotracheitis, and calicivirus. It is important to return for a followup booster in 3-4 weeks. Occasionally listlessness, lethargy, or localized discomfort may occur. If there is severe listlessness or facial swelling, please call us for advice.					
08-14-25		1	Recommend-Fecal (please dropoff			0.00
	Annual fecal microscopic exams are very important for the health of your pet and, since some worms are transmissible to humans, for the health of your family. Please bring us your pet's fecal sample at your earliest convenience					
08-14-25		1	Zoonoses			0.00
	Discussed Zoonotic potential of intestinal parasites- in particular roundworms.					
08-14-25		1	Weight Monitoring			0.00

Copy

08-15-25	1 Feline Leukemia Elisa Negative	0.00
08-15-25	1 FIV Elisa Negative	0.00
<hr/>		
Total charges, this invoice...		85.80
**Total discount included: 195.80		

Your invoice total reflects our **13Stray Cat Accounts** discount.

Reminders for: **Priscilla 27k25** (Weight: 1.3 lbs - 10w) Last done

02/26	FECAL KEYScreen PCR
12/25	FECAL EXAM
10/25	Rabies/Purevax Feline 1yr
10/25	Spay your pet at 5-6 months
09/25	FVRCP Feline #2

Reminders for: **Elvis-26k25** (Weight: 1.2 lbs - 10w) Last done

02/26	FECAL KEYScreen PCR
12/25	FECAL EXAM
10/25	Rabies/Purevax Feline 1yr
10/25	Neuter your pet at 5-6 months
09/25	FVRCP Feline #2

Priscilla 27k25's weight history (in lbs)

08-14-25	1.30
----------	------

Elvis-26k25's weight history (in lbs)

08-14-25	1.20
----------	------

LIKE US ON FACEBOOK.COM!

GOING AWAY?....BOOK YOUR PETS BOARDING RESERVATION TODAY!

In compliance with New York State law, all medications are non-refundable. We regret any inconveniences.

COPY

INVOICE

Newburgh Veterinary Hospital

1716 Route 300
Newburgh, NY 12550
845 564-2660

"Your pet is part of our family too." Visit us at www.newburghvet.com

FOR: Town of Newburgh - Feline
645 Gidney Ave.
Newburgh, NY 12550
(845) 561-3344

Printed: 08-26-25 at 4:07p
Date: 08-20-25
Account: 4417
Invoice: 939839

Date	For	Qty	Description	Price	Discount	Net Price
08-20-25	Rebel 19k25	1	Ophth- Tobramycin Ophth Solution	30.35	26.51	3.84 **
Total charges, this invoice...						3.84
**Total discount included: 26.51						

Your invoice total reflects our **13Stray Cat Accounts** discount.

LIKE US ON FACEBOOK.COM!

GOING AWAY?....BOOK YOUR PETS BOARDING RESERVATION TODAY!

In compliance with New York State law, all medications are non-refundable. We regret any inconveniences.

COPY

INVOICE

Newburgh Veterinary Hospital

1716 Route 300
Newburgh, NY 12550
845 564-2660

"Your pet is part of our family too." Visit us at www.newburghvet.com

FOR: Town of Newburgh - Feline
645 Gidney Ave.
Newburgh, NY 12550
(845) 561-3344

Printed: 08-26-25 at 4:07p
Date: 08-20-25
Account: 4417
Invoice: 939841

Date	For	Qty Description	Price	Discount	Net Price
08-20-25	Rocky	1 Feline Rhino/Panleuk/Calicivirus #	52.00	35.00	17.00 **
Your cat has received the second in a series of immunizations to protect her/him against Feline Distemper, Rhinotracheitis, and Calicivirus. It is important to return for a final booster in 3-4 weeks. Occasionally listlessness or localized discomfort might occur for the next few days. If you notice excessive listlessness or facial swelling, please call us for advice.					

Total charges, this invoice...

17.00

**Total discount included: 35.00

Your invoice total reflects our **13Stray Cat Accounts** discount.

Reminders for: Rocky (Weight: 1.7 lbs - 11w)	Last done
01/26	FECAL KEYSERSCREEN PCR
12/25	FECAL EXAM
10/25	Rabies/Purevax Feline 1yr
10/25	Neuter your pet at 5-6 months
09/25	Rhinotracheitis/Pan/leuk/Calic

Rocky's weight history (in lbs)

08-03-25	1.74
07-29-25	1.64
07-27-25	1.56
07-20-25	1.38
07-15-25	1.25
07-13-25	1.20
07-10-25	1.16

LIKE US ON FACEBOOK.COM!

GOING AWAY?....BOOK YOUR PETS BOARDING RESERVATION TODAY!

COPY

INVOICE

Newburgh Veterinary Hospital

1716 Route 300
Newburgh, NY 12550
845 564-2660

"Your pet is part of our family too." Visit us at www.newburghvet.com

FOR: Town of Newburgh - Feline
645 Gidney Ave.
Newburgh, NY 12550
(845) 561-3344

Printed: 08-26-25 at 4:07p
Date: 08-22-25
Account: 4417
Invoice: 940034

Date	For	Qty	Description	Price	Discount	Net Price
08-22-25	Bullwinkle	1	Feline Rhino/Panleuk/Calicivirus #	52.00	35.00	17.00 **
	Your cat has received the second in a series of immunizations to protect her/him against Feline Distemper, Rhinotracheitis, and Calicivirus. It is important to return for a final booster in 3-4 weeks. Occasionally listlessness or localized discomfort might occur for the next few days. If you notice excessive listlessness or facial swelling, please call us for advice.					

Total charges, this invoice...

17.00

**Total discount included: 35.00

Your invoice total reflects our **13Stray Cat Accounts** discount.

Reminders for: Bullwinkle (Weight: 1.9 lbs - 11w)		Last done
07/26	FECAL KEYScreens PCR	07-29-25
12/25	FECAL EXAM	
10/25	Rabies/Purevax Feline 1yr	
10/25	Neuter your pet at 5-6 months	
09/25	Rhinotracheitis/Pan/leuk/Calic	

Bullwinkle's weight history (in lbs)

08-03-25	1.86
07-29-25	1.82
07-27-25	1.56
07-20-25	1.42
07-15-25	1.30
07-13-25	1.24
07-10-25	1.17

LIKE US ON FACEBOOK.COM!

GOING AWAY?....BOOK YOUR PETS BOARDING RESERVATION TODAY!

COPY

INVOICE

Newburgh Veterinary Hospital

1716 Route 300
Newburgh, NY 12550
845 564-2660

"Your pet is part of our family too." Visit us at www.newburghvet.com

FOR: Town of Newburgh - Feline
645 Gidney Ave.
Newburgh, NY 12550
(845) 561-3344

Printed: 08-26-25 at 4:07p
Date: 08-23-25
Account: 4417
Invoice: 940180

Date	For	Qty	Description	Price	Discount	Net Price
08-23-25	Summer 28k25	1	CONSULT / EXAM - Sick	105.00	66.50	38.50 **
08-23-25		1	OSHA Compliance Biohazards Fee	12.60	6.30	6.30 **
08-23-25		1	Subcutaneous fluids injection	98.50	49.25	49.25 **
08-23-25		1	X-RAY-Followup Views Kitten	224.00	112.00	112.00 **
08-23-25		1	Sedation for Imaging,i.v.catheter	139.00	69.50	69.50 **
08-23-25		0.02	-TelazolInject Control Log / ml			0.00
08-23-25		1	Shelter euthanasia and body care f			126.00
08-23-25		1	Euthanasia - Somlethol Pent Contr			0.00

Total charges, this invoice...

401.55

**Total discount included: 303.55

Your invoice total reflects our **13Stray Cat Accounts** discount.

LIKE US ON FACEBOOK.COM!

GOING AWAY?....BOOK YOUR PETS BOARDING RESERVATION TODAY!

In compliance with New York State law, all medications are non-refundable. We regret any inconveniences.

COPY



#8B

TOWN OF NEWBURGH ANIMAL CONTROL & SHELTER

645 GIDNEY AVE. NEWBURGH, NY 12550

TEL: (845)561-3344

FAX: (845) 561-2220

To: Town Board

From: Tracey Carvell, Animal Control

Subject: Authorization to pay Vet Services Utilizing Account 5144

Date: 8-26-25

I am requesting authorization to pay for Vet service: F.A.H.

*Totaling: \$ 50.95

Canine: \$ 50.95

Feline: \$

Other: \$

TOWN OF NEWBURGH
 1488 ROUTE 300
 NEWBURGH, N.Y. 12550

VOUCHER

#78 569

DEPARTMENT TENAC

CLAIMANT'S
NAME
AND
ADDRESS

VCA Flannery Animal Hospital
 789 Little Britain Road
 New Windsor, NY 12553

TERMS

August 2025 Voucher

Order No.

DO NOT WRITE IN THIS BOX

Date Voucher Received

FUND - APPROPRIATION

AMOUNT

TOTAL

Abstract No.

Vendor's
Ref. No.

Date	Quantity	Description of Materials or Services	Unit Price	Amount
8-11-25	INV# 5356760432	2025-08-11 Husky (F)	50.95	
(See Instructions on Reverse Side)			TOTAL	50.95

CLAIMANT'S CERTIFICATION

I, Jean Tobin, certify that the above account in the amount of \$ 50.95 is true and correct; that the items, services and disbursements charged, were rendered to or for the municipality on the dates stated; that no part has been paid or defrayed; that taxes, from which the municipality is exempt, are not included; and that the amount claimed is actually due.

8-14-25
DATE

Jean Tobin
SIGNATURE

Acet Manrique
TITLE

(Space Below for Municipal Use)

DEPARTMENT APPROVAL

The above services or materials were rendered or furnished to the municipality on the dates stated and the charges are correct.

8/14/25
DATE

[Signature]
AUTHORIZED OFFICIAL

APPROVAL FOR PAYMENT

This claim is approved and ordered paid from the appropriations indicated above.



VCA Flannery Animal Hospital PC
789 Little Britain Rd. | New Windsor, NY 12553 | (845) 565 - 7387

Dr. Stillman | Date: 8/12/2025 at 11:52 | Invoice: 5356760432 | Cashier: Jean T

Client

Town Of Newburgh 2025 Animal Control (#78569)
Tracey ACO
645 Gidney Ave
Newburgh, NY 12550

Patient

2025-08-11 Husky (#170696)
Species: Canine (Husky, Siberian Mix)
Sex: Female | Color: Black And White
Birth: | Age: | Weight: 47 lb

Detailed Visit Information

Date	Description	Qty	Price	Tax	Total Price
8/11/2025	Boarding Animal Control	1.00	\$50.95	\$0.00	\$50.95
8/12/2025	Boarding Go Home Day	1.00	\$0.00	\$0.00	\$0.00

Subtotal: **\$50.95**

A Message from VCA

Please note all prescription refill request require at least 24-hour notice. For home delivery, download the myVCA app.

Invoice Summary

Patient Name	Total Price	Total Tax	Total Due
2025-08-11 Husky	\$50.95	\$0.00	\$50.95

Prev Balance:	
Total Due:	\$50.95
Amount Paid:	\$0.00
Amount Due:	

For information on how we collect and use information about you and your pet, and how you may opt-out of some uses, please see our Privacy Policy at vcahospitals.com/privacy-policy.

Thank you for trusting us with your pet's care. Your friends at VCA Flannery Animal Hospital PC.



#10A

18 August 2025

Town of Newburgh
1496 Route 300
Newburgh, NY 12550

**RE: Newburgh Recreation Center
Change Order 18 – Mezzanine Steel Opening**

Summary: Additional cost to refabricate and relocate structural steel framed opening to accommodate access ladder at Mechanical Attic 202 per SK-06.

Change Order Amount: \$2,190.00

Respectfully submitted,

MHE Engineering, D.P.C.

A handwritten signature in black ink, appearing to read 'Michael J. Lamoreaux', written over a horizontal line.

Michael J. Lamoreaux, P.E.
Principal

NEW YORK OFFICE

33 Airport Center Drive, Suite 202, New Windsor, NY 12553
845-567-3100 | F: 845-567-3232 | mheny@mhepc.com

PENNSYLVANIA OFFICE

111 Wheatfield Drive, Suite 1, Milford, PA 18337
570-296-2765 | F: 570-296-2767 | mhepa@mhepc.com

CHANGE ORDER NO.: 18

Owner: **Town of Newburgh**
 Engineer: **MHE Engineering, D.P.C.**
 Contractor: **O'Connor Company**
 Project: **Newburgh Recreation Center Project**
 Contract Name: **General Construction**
 Date Issued: **7/16/2025**

Owner's Project No.:
 Engineer's Project No.: **21-135**
 Contractor's Project No.:

Effective Date of Change Order: **7/16/2025**

The Contract is modified as follows upon execution of this Change Order:

Description:

- **Refabricate and relocate steel mezzanine opening to accommodate access ladder relocation per SK-06.**

Attachments:

- **O'Connor PCO-027 dated 5/22/2025**

Change in Contract Price		Change in Contract Times [State Contract Times as either a specific date or a number of days]	
Original Contract Price:		Original Contract Times:	
\$ <u>12,106,100.00</u>		Substantial Completion: <u>480 Days</u>	
		Ready for final payment: <u>510 Days</u>	
Increase from previously approved Change Orders No. 1 to No.17:		[Increase] [Decrease] from previously approved Change Orders No.1 to No.1 [Number of previous Change Order]:	
\$ <u>208,074.41</u>		Substantial Completion: <u>N/A</u>	
		Ready for final payment: <u>N/A</u>	
Contract Price prior to this Change Order:		Contract Times prior to this Change Order:	
\$ <u>12,314,174.41</u>		Substantial Completion: <u>N/A</u>	
		Ready for final payment: <u>N/A</u>	
Increase this Change Order:		[Increase] [Decrease] this Change Order:	
\$ <u>2,190.00</u>		Substantial Completion: <u>N/A</u>	
		Ready for final payment: <u>N/A</u>	
Contract Price incorporating this Change Order:		Contract Times with all approved Change Orders:	
\$ <u>12,316,364.41</u>		Substantial Completion: <u>480 Days</u>	
		Ready for final payment: <u>510 Days</u>	

Recommended by Construction Manager

By: Diego Frangiamone
 Title: Clerk of the Work
 Date: 8.22.25

Recommended By Engineer

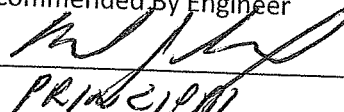
PRINCIPAL
8/26/25

Authorized by Owner

By: _____
 Title: _____

Accepted by Contractor

Ken Welman
Sr. PM
7/29/25

Date:



312 Fields Drive
Aberdeen, NC 28315
Phone 910 944 0600
Fax 910 944 1888

Additional Work/Change Order Request

To: ☒ Architect
☐ Engineer

MHE Engineering

Date:

05/22/2025

☒ Owner

Town of Newburgh

From:

Ken Welman

Purpose of Request: ☐ Required by Code Official
☒ Requested By Owner
☒ Requested by Architect
☒ Other

Change
Order
Number:

GC PCO 027

Project: Newburgh Recreation Center at Chadwick Lake Park

Change Order Request

- This change order is for SK-6 in response to RFI 067 Mezzanine Opening refabricate and relocate framed opening to accommodate ladder relocation.

Subcontractor Subtotal: \$2,025.00
Insurance (1%): \$20.00
Bonding (2%): \$41.00
OH&P (5%): \$104.00
TOTAL CHANGE COST: \$2,190.00

Approval:

☐ Approved

☐ Denied

☐ Request Additional
Information

Owner Comments:

REQUEST FOR CHANGE ORDER

MSC STEEL, LLC

17 INDUSTRIAL PARKWAY GLOVERSVILLE, NY 12078

Phone 518-921-4371

Fax 518-921-4447

E-Mail mcalkins@msc-ny.com

To: O'Connor Company

Attn: Mr. Ken Wellman

Project: Newburgh Rec Center

ID NUMBER

From: Matthew Calkins

Date: 4/22/2025

Work Activity Sheet Nu.

133

CO #5

Ref.

We respectfully submit to your firm a proposal for additional work to be performed for the above project as follows. REFABRICATE AND RELOCATE FRAMED OPENING IN BUILDING C MEZZANINE TO ACCOMMODATE LADDER RELOCATION

FIELD LABOR COST

CLASSIFICATION	Hours	Rate	Sub Total
2 IW Journeyman	8	\$ 115.03	\$ 1,840.48
IW Foreman		\$ -	\$ -
Fabrication		\$ -	\$ -
Operator		\$ -	\$ -
FIELD LABOR SUB TOTAL			\$ 1,840.48

CRANES

Description	Quantity	Unit	Price per.	Sub. Total
-------------	----------	------	------------	------------

CRANE SUB TOTAL \$ -**LIFTS**

Description	Quantity	Unit	Price per.	Sub. Total
60'-0 Boom				\$ -
45'-0 Boom				\$ -
40'-0 Boom				\$ -
19'-0 Scissor				\$ -
32'-0 Scissor				\$ -
5K LUL				\$ -
8K LUL				\$ -
10K LUL				\$ -
Welding Rod	lbs			\$ -
Grinding Wheels	ea			\$ -
				\$ -

LIFTS SUBTOTAL \$ -**TOOLS/EQUIPMENT/CONSUMABLES COST**

Description	Quantity	Unit	Price per.	Sub. Total
Truck/ladders		day	\$ 100.00	\$ -
400A Welder		day	\$ 25.00	\$ -
Torch/Gas		day	\$ 10.00	\$ -
Hammer Drill		day	\$ 5.00	\$ -
Mag Drill		day	\$ 7.00	\$ -
Grinder		day	\$ 5.00	\$ -
Chain Hoist		day	\$ 35.00	\$ -
"Genie" Lift		day	\$ 45.00	\$ -
Roust A Bout		day	\$ 100.00	\$ -
			\$ -	\$ -
Fuel	gal	\$ 3.65		\$ -

TOOLS/EQUIPMENT SUB TOTAL \$ -**SUMMARY**

FIELD LABOR	\$ 1,840.48
CRANE	\$ -
LIFTS	\$ -
TOOLS/EQUIPMENT/CONSUMABLES	\$ -
SUB TOTAL	\$ 1,840.48
10% OVERHEAD AND PROFIT	\$ 184.05

GRAND TOTAL**\$ 2,025.00****ADJUSTMENTS**

\$	2,024.53
\$	0.47

Yours Truly,

Estimating Dept.

AS PER CONTRACT - ANY EXTRA WORK MUST BE AUTHORIZED WITH A WRITTEN CHANGE ORDER



#133

17 Industrial Pkwy
Gloversville, NY 12078

Tel: (518) 921-4371

Fax: (518) 921-4447

ADDITIONAL WORK ORDER

DATE: 4/8/25

PROJECT: Newburgh Rec Center

JOB #: 24-031

MSC STEEL, LLC IS HEREBY AUTHORIZED TO PERFORM THE FOLLOWING WORK AS ACCEPTED

DESCRIPTION: Refabricate CLIPS and JOIST SUPPORT FOR
MEZZANINE IN BUILDING C

COST BREAKDOWN

LABOR	QUANTITY	HOURS	EXTENSION
IRONWORKER FOREMAN			
IRONWORKER JOURNEYMAN	2	8	
OPERATING ENGINEER			
OILER			

EQUIPMENT	QUANTITY	HOURS	EXTENSION
CRANE			
WELDER			
FORKLIFT/LUL			
JLG			
SCISSORS LIFT			
GENIE LIFT			

MISC. EXPENSES	QUANTITY	HOURS	EXTENSION
TRAVEL			
CONSUMABLES			

ADDITIONAL WORK IS TO BE PERFORMED IN ACCORDANCE WITH ORIGINAL CONTRACT DOCUMENTS AND SUBCONTRACT AGREEMENT

CONTRACTOR'S REPRESENTATIVE: ROB RUTLER

PRINT

SIGNATURE

04-16-25

DATE



REQUEST FOR INTERPRETATION

Project: Newburgh Recreation Center

R.F.I. Number: 067

To: Holt / MHE

From: O'Connor

Date: 02/18/25

Re: Roof Hatch Design

A/E Project Number: _____

Contract For: _____

Specification Section: _____

Paragraph: _____

Drawing Reference: _____

Detail: _____

Request:

See attached documents

- RFI

Signed by: Molly Hentz

Date: 02/18/25

Response:

SEE RESPONSES ON PAGE 2.

☒ Attachments

Response From: _____

To: _____

Date Rec'd: _____

Date Ret'd: _____

Signed by: _____

Date: _____

Copies: _____

☐

☐ Owner

☐ File

☐ Consultants

☐

☐

☐

1. Roof Hatch Design Concerns

The roof hatch shown on the drawings appears to be a modified version of a standard roof hatch intended for mezzanine access. However, there are concerns regarding the current design.

The hatch appears to be 12 inches high, requiring a vertical clearance that does not align with safe access requirements. The current design does not provide clarity on which direction the hatch opens. There is no clear means of support for someone transitioning through the hatch, which raises potential life safety issues. There is a 2'-0" high opening, requiring additional safety considerations.

Can the hatch design be revised to provide a safer transition, such as a flush floor access door with proper structural support?

Can you confirm the intended hatch configuration, including the opening direction and safety provisions? SEE SK-6 TO CHANGE LOCATION OF HATCH FOR EASIER OPERATION

2. Safety Features

To enhance safety and accessibility for personnel using the hatch, we recommend the following additions: THESE ARE NOT REQUIRED BY THE BUILDING CODE AND WERE NOT PART OF THE BID DOCUMENTS

A safety "pogo" stick should be included within the frame to assist with climbing through the opening.

A mezzanine floor-mounted safety cage should be installed at 42" AFF, surrounding two sides of the opening without interfering with climbing up and out. Can you confirm if this can be included in the design?

3. Additional Mezzanine Lighting Switch

Currently, the mezzanine lighting switch is located on the east wall. For added convenience and safety, we request an additional switch to be located at the north wall near the hatch.

Can an additional lighting switch be added near the north wall adjacent to the hatch?

ADD SWITCH IN CLOSET NEAR LADDER

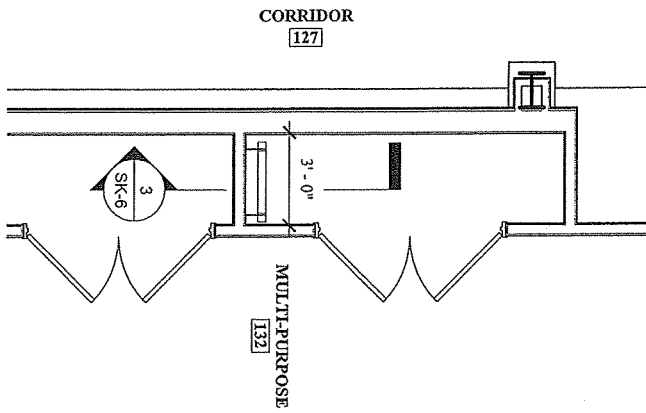

1 PARTIAL PLAN
SK-6 SCALE: 1/4" = 1'-0"

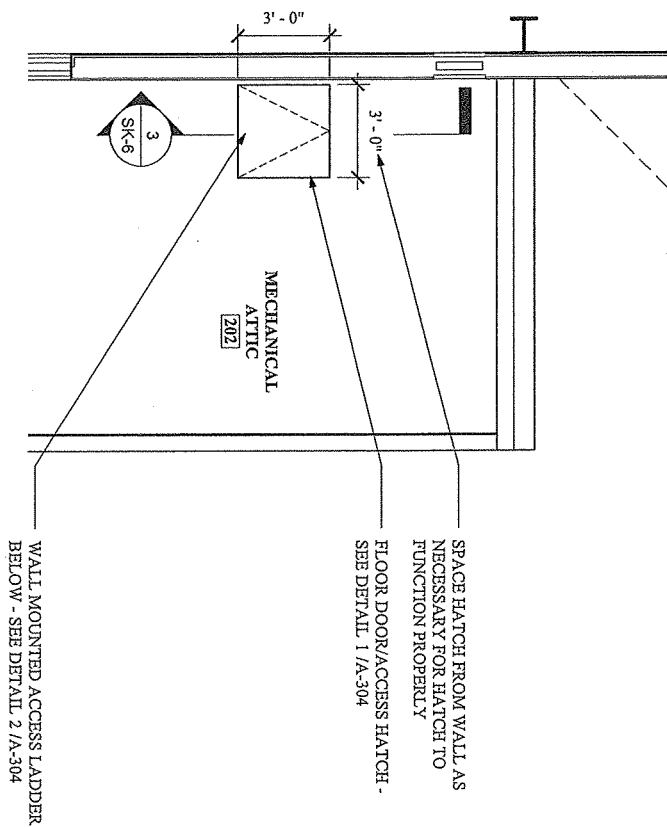

2 PARTIAL ATTIC PLAN
SK-6 SCALE: 1/4" = 1'-0"

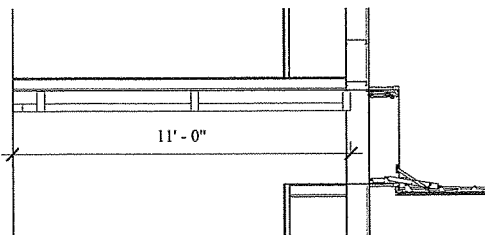

3 ACCESS LADDER
SK-6 SCALE: 1/4" = 1'-0"

WHE
ENGINEERING
33 Airport Center Drive
New Milford, NY 12553
(845) 667-3100
111 Wheatfield Drive
Shawangunk, PA 18327
(570) 265-2765

NEW RECREATION CENTER

TOWN OF NEWBURGH

DRAWN BY:	SK-6
REVIEWED BY:	
PROJECT # 21-135	
PHASE #	ISSUED DATE: 02/25/25



#10B

18 August 2025

Town of Newburgh
1496 Route 300
Newburgh, NY 12550

**RE: Newburgh Recreation Center
Change Order 19 – Type D Pendant Fixtures**

Summary: Additional cost to furnish and install Type D pendant light fixtures at ceilings of Corridor 127 and Storage Room 138 in lieu of specified lay-in type fixtures per RFI-095 Response.

Change Order Amount: \$11,470.00

Respectfully submitted,

MHE Engineering, D.P.C.

A handwritten signature in black ink, appearing to read 'Michael J. Lamoreaux', written over a horizontal line.

Michael J. Lamoreaux, P.E.
Principal

NEW YORK OFFICE

33 Airport Center Drive, Suite 202, New Windsor, NY 12553
845-567-3100 | F: 845-567-3232 | mheny@mhepc.com

PENNSYLVANIA OFFICE

111 Wheatfield Drive, Suite 1, Milford, PA 18337
570-296-2765 | F: 570-296-2767 | mhepa@mhepc.com

CHANGE ORDER NO.: 19

Owner: Town of Newburgh	Owner's Project No.:
Engineer: MHE Engineering, D.P.C.	Engineer's Project No.: 21-135
Contractor: O'Connor Company	Contractor's Project No.:
Project: Newburgh Recreation Center Project	
Contract Name: General Construction	
Date Issued: 7/16/2025	Effective Date of Change Order: 7/16/2025

The Contract is modified as follows upon execution of this Change Order:

Description:

- **Furnish & Install Type D pendant light fixtures at Corridors in lieu of drop-in type C6 fixtures per RFI-095 response.**

Attachments:

- **O'Connor PCO-030 dated 7/1/2025**

Change in Contract Price		Change in Contract Times [State Contract Times as either a specific date or a number of days]	
Original Contract Price:		Original Contract Times:	
\$ <u>12,106,100.00</u>		Substantial Completion: <u>480 Days</u>	
		Ready for final payment: <u>510 Days</u>	
Increase from previously approved Change Orders No. 1 to No.18:		[Increase] [Decrease] from previously approved Change Orders No.1 to No.1 [Number of previous Change Order]:	
\$ <u>210,264.41</u>		Substantial Completion: <u>N/A</u>	
		Ready for final payment: <u>N/A</u>	
Contract Price prior to this Change Order:		Contract Times prior to this Change Order:	
\$ <u>12,316,364.41</u>		Substantial Completion: <u>N/A</u>	
		Ready for final payment: <u>N/A</u>	
Increase this Change Order:		[Increase] [Decrease] this Change Order:	
\$ <u>11,470.00</u>		Substantial Completion: <u>N/A</u>	
		Ready for final payment: <u>N/A</u>	
Contract Price incorporating this Change Order:		Contract Times with all approved Change Orders:	
\$ <u>12,327,834.41</u>		Substantial Completion: <u>480 Days</u>	
		Ready for final payment: <u>510 Days</u>	

Recommended by Construction Manager

By: Diego Frangiamone
 Title: Clerk of the Work
 Date: 7/28/25

Authorized by Owner

By: _____
 Title: _____

Recommended By Engineer

[Signature]
Principal
8/26/25

Accepted by Contractor

Ken Welman
Sr. Project Manager
7/22/25

Date:



312 Fields Drive
Aberdeen, NC 28315
Phone 910 944 0600
Fax 910 944 1888

Additional Work/Change Order Request

To: ☒ Architect
☐ Engineer

MHE Engineering

Date:

07/01/25

☒ Owner

Town of Newburgh

From:

Ken Welman

Purpose of Request: ☐ Required by Code Official
☒ Requested By Owner
☒ Requested by Architect
☒ Other

Change
Order
Number:

GC PCO 030

Project:

Newburgh Recreation Center at Chadwick Lake Park

Change Order Request

- This change order is for RFI 095, furnish and install Type D Pendants in open ceiling in lieu of drop in Type C6.

Subcontractor Subtotal: \$10,603.58
Insurance (1%): \$106.00
Bonding (2%): \$214.00
OH&P (5%): \$546.00
TOTAL CHANGE COST: \$11,470.00

Approval:

☐ Approved

☐ Denied

☐ Request Additional
Information

Owner Comments:

CHANGE ESTIMATE 007

PERRECA ELECTRIC CO. INC

520 BROADWAY
PO BOX 2530
NEWBURGH NY 12550
(845) 562-4080

PROPOSAL SUBMITTED TO:

Name O'Connor Company

Date 6/7/225

Address 11828 US HWY 15/501
Aberdeen, NC 28315

Phone 1-774-265-5198

Fax

Attn: Ken Welman

Job Name NEWBURGH REC - Install Pendant Type D in lieu of C6

We hereby submit specifications and estimates for:

Furnish labor and materials for to install Type D Pendant mount fixtures in open ceiling ion lieu of drop in C6 as shown on drawings.

Clarifications

1. Labor consists of 2 men for 26 Hours @ \$106.23=	\$2,761.98
1 HOUR Project Manager	199.90
Lighting Quote \$ 6,440.00 10%	\$7,084.00
Materials \$ 507.00 10%	557.70
	<hr/>
Total	\$10,603.58

10 Type C6 fixtures to be turned over to Owner for Attic Stock

We Propose hereby to furnish material and labor for the sum of

\$ 10,603.00

TEN THOUSAND SIX HUNDRED AND THREE

and 00/100 dollar

Payment to be made as follows:

Upon Completion

All work to be completed in a workmanlike manner according to standard Practices. Any alteration or deviation from above specifications involving extra costs will be executed only upon written orders, and will become an extra charge over and above the estimate. All agreements contingent upon strikes, accidents, or delays beyond our control. Owner to carry fire, tornado and other necessary insurance. Our workers are fully covered by Workmen's Compensation Insurance.

Authorized
Signature

Spyros Manouvelos

Spyros Manouvelos

This proposal may be withdrawn
by us if not accepted within 30 days.

Acceptance of Proposal -The above prices, specifications and conditions are satisfactory and are hereby accepted. You are authorized to do the work as specified. Payment will be made as outlined above

Date of Acceptance _____

Signature _____



REQUEST FOR INTERPRETATION

Project: Newburgh Recreation Center

R.F.I. Number: 095

To: Holt / MHE

From: Perreca

Date: 05/06/2025

Re: Lighting Fixture Adjustment

A/E Project Number: _____

Contract For: _____

Specification Section: _____

Paragraph: _____

Drawing Reference: _____

Detail: _____

Request:

Due to a recent directive to construct a sloped drywall ceiling tight to structure above in Corridor 127 and Storage Room 138, the originally specified lay-in type fixtures shown on the Reflected Ceiling Plan are no longer feasible.

To accommodate the new ceiling condition, we propose using D-Type pendant-mounted fixtures at the following locations:

(9) pendant-mounted fixtures in Corridor 127

(2) pendant-mounted fixtures in Storage Room 138

Signed by: Molly Hentz

Date: 05/06/2025

Response:

JSE takes no exception to the Type D fixtures being utilized within Corridor 128.

Contractor to coordinate in field with final mounting locations. Within Storage Room 138 contract drawings indicate recessed Type C6 fixture. Contractor to verify these fixtures will not work within sloped ceiling prior to replacement. If determined type D is required one (1) type D centered in room is sufficient.

MLI JSE 5/7/25

☐ Attachments

Response From: _____

To: _____

Date Rec'd: _____

Date Ret'd: _____

Signed by: _____

Date: _____

Copies: _____



☐ Owner

☐ File

☐ Consultants









First in the Long Run

Freight per Manufacturer's terms.
Plus tax, if applicable.
Subject to approval.
Confirm quantities and catalog numbers.
Confirm voltage of fixtures and color of the lamps.
Prepayment to shipment may be required.
Quote valid for 30 days from date above.



Takeoff

Vendor: TARGET Labor Level: LABOR 1 17 Jun 2025 11:47:03

Phase: CHANGE ORDERS
 SubPhase: CO 07 RFL 95TYPE D LIGHTING

Item #	Qty	U/M	Q/M	Size	Description	Material Unit	Material Result
	0.00				CREDIT LAY C6 IN FIXTURES		
TITLE	-10.00		M	#12	L.E.D. 2X2 LAY-IN /T-BAR	0.0000	0.00
120600	-10.00	EA	M	2 x 2	T-BAR LAY-IN L.E.D. LUMINAIRE-LABOR	0.0000	0.00
100105	-10.00	EA	M	18-12 3A	PSH-IN 2-WIRE DISCONNECT	0.9809	-9.81
120891	-40.00	EA	M	515A	LAY-IN CLIP UPTURNED LP	0.7577	-30.31
120895	-110.00	FT	M		DROP WIRE (COLORED)	0.0000	0.00
70287	-100.00	FT	M	12/3	MC CABLE - ALUM JKT W/G	0.7597	-75.97
630388	-10.00	EA	M	14>10-3 (2-CBL)	AC/MC HMR-ON BOT-MTD 1/4-FLNG HGR PSH-IN	2.3350	-23.35
160675	-20.00	EA	M	7"	TY-WRAP	0.2859	-5.72
670083	-9.00	EA	M	3/8 (3838AST)	AC/MC FLEX DX SNAP 2-IT CONN- INSUL	2.4035	-21.63
	0.00				ADD TYPE D PENDENT MOUNTS		
TITLE	10.00		M	#12	IND-SHADE FLUOR SURFACE /STL-BEAM	0.0000	0.00
120154	10.00	EA	M	48"	SURFACE INDSTL-SHADE 2-LAMP-FLUOR	0.0000	0.00
640128	20.00	EA	M	1/4-20 x 3/8 STUP	BOT-MNT RETANR HAMMER-ON 1/2"BEAM STRP	7.4842	149.68
100103	10.00	EA	M	18-12 6A	PSH-IN 2-WIRE DISCONNECT	1.5259	15.26
100108	30.00	EA	M	18-12	PSH-IN 2-WIRE CONN	0.1372	4.12
100110	30.00	EA	M	18-12	PSH-IN 4-WIRE CONN	0.1567	4.70
100096	10.00	EA	M	#12	PIGTAIL W/GRD SCREW	13.5041	135.04
10047	100.00	FT	M	3/4	EMT	0.8518	85.18
630081	12.00	EA	M	3/4	COND HAMMER-ON HGR 1/2-FLNG SNP-CLOSE	2.6505	31.81
					HD		
30137	10.00	EA	M	3/4	EMT STEEL-COMP COUPLING	1.9123	19.12
30217	20.00	EA	M	3/4	EMT STEEL COMP CONNECTOR	1.7493	34.99
70033	360.00	FT	M	12	THHN/THWN CU (STR)	0.4024	144.86
70118	120.00	FT	M	12	GREEN THHN CU (GRD 20A)	0.4124	49.49
Phase Totals:							507.45

Perreca Electric Co., Inc.

520 Broadway
 Newburgh, NY 12550

Phone: 845-649-4822
 Web: www.perreca.com



#10C

18 August 2025

Town of Newburgh
1496 Route 300
Newburgh, NY 12550

**RE: Newburgh Recreation Center
Change Order 20 – Paint Color Change**

Summary: Additional cost for purchase of non-refundable interior paint that was furnished before the interior finish schedule was revised.

Change Order Amount: \$1,344.00

Respectfully submitted,

MHE Engineering, D.P.C.

A handwritten signature in black ink, appearing to read 'Michael J. Lamoreaux', written over a horizontal line.

Michael J. Lamoreaux, P.E.
Principal

NEW YORK OFFICE

33 Airport Center Drive, Suite 202, New Windsor, NY 12553
845-567-3100 | F: 845-567-3232 | mheny@mhepc.com

PENNSYLVANIA OFFICE

111 Wheatfield Drive, Suite 1, Milford, PA 18337
570-296-2765 | F: 570-296-2767 | mhepa@mhepc.com

CHANGE ORDER NO.: 20

Owner: Town of Newburgh	Owner's Project No.:
Engineer: MHE Engineering, D.P.C.	Engineer's Project No.: 21-135
Contractor: O'Connor Company	Contractor's Project No.:
Project: Newburgh Recreation Center Project	
Contract Name: General Construction	
Date Issued: 7/16/2025	Effective Date of Change Order: 7/16/2025

The Contract is modified as follows upon execution of this Change Order:

Description:

- **Purchase of 25 Gallons of non-refundable paint that was purchased before revision of interior finish schedule.**

Attachments:

- **O'Connor PCO-031 dated 7/1/2025**

Change in Contract Price		Change in Contract Times [State Contract Times as either a specific date or a number of days]	
Original Contract Price:		Original Contract Times:	
\$ 12,106,100.00		Substantial Completion: 480 Days	
		Ready for final payment: 510 Days	
Increase from previously approved Change Orders No. 1 to No.19:		[Increase] [Decrease] from previously approved Change Orders No.1 to No.1 [Number of previous Change Order]:	
\$ 221,734.41		Substantial Completion: N/A	
		Ready for final payment: N/A	
Contract Price prior to this Change Order:		Contract Times prior to this Change Order:	
\$ 12,327,834.41		Substantial Completion: N/A	
		Ready for final payment: N/A	
Increase this Change Order:		[Increase] [Decrease] this Change Order:	
\$ 1,344.00		Substantial Completion: N/A	
		Ready for final payment: N/A	
Contract Price incorporating this Change Order:		Contract Times with all approved Change Orders:	
\$ 12,329,178.41		Substantial Completion: 480 Days	
		Ready for final payment: 510 Days	

<p>Recommended by Construction Manager</p> <p>By: <u>Diego Frangiamone</u></p> <p>Title: <u>Clerk of the Work</u></p> <p>Date: <u>7/28/25</u></p> <p>Authorized by Owner</p> <p>By: _____</p> <p>Title: _____</p>	<p>Recommended By Engineer</p> <p><u><i>[Signature]</i></u></p> <p><u>PRINCIPAL</u></p> <p><u>8/26/25</u></p> <p>Accepted by Contractor</p> <p><u>Ken Welman</u></p> <p><u>Sr. Project Manager</u></p> <p><u>7/22/25</u></p>
---	--

Date:



312 Fields Drive
Aberdeen, NC 28315
Phone 910 944 0600
Fax 910 944 1888

Additional Work/Change Order Request

To: ☒ Architect
☐ Engineer

MHE Engineering

Date:

07/01/25

☒ Owner

Town of Newburgh

From:

Ken Welman

Purpose of Request: ☐ Required by Code Official
☒ Requested By Owner
☒ Requested by Architect
☒ Other

Change
Order
Number:

GC PCO 031

Project:

Newburgh Recreation Center at Chadwick Lake Park

Change Order Request

- This change order is for the purchase of 25 gallons of non-refundable and unusable paint and topcoat that was obtained before the second revision of the finish schedule was issued on 5/9/25.

Subcontractor Subtotal: \$1,242.30
Insurance (1%): \$12.00
Bonding (2%): \$25.00
OH&P (5%): \$64.00
TOTAL CHANGE COST: \$1,344.00

Approval:

☐ Approved

☐ Denied

☐ Request Additional
Information

Owner Comments:



VISLOCKY PAINTING

Commercial and Industrial Painting

300 New Hempstead Rd New City, NY 845-638-1403

PROPOSAL

DATE: 5/22/25

TO: O'Connor Company

ATTN: Estimating / Project Management

RE: Newburgh Recreation Center Chadwick Lake Park

Interior Painting

DESCRIPTION OF WORK PERFORMED:

Vislocky Painting to Provide all Labor Materials and Supervision in accordance with request from Oconnor Personnel

GYMNASIUM RE-PAINTING

1. Repainting of GWB Walls in (Gymnasium 125) using Promar 200 Eggshell Morning Fog 6225, as requested on Paint Schedule issued to Vislocky Painting May 21, 2025
2. Walls Previously Primed and Finish Painted As of 5/21/25 using Extra White 7006
3. Including cost of extension of Scissor Lift Rental for Access (1 Week)
4. Including costs of additional material
5. No priming required for repainting.

Gymnasium Re-Painting Work for The Sum Of
(\$12,000.00) Dollars

MATERIAL COSTS

1. 25 Gallons of Paint (Daphne 9151, Distance 6243 etc) purchased prior to issuance of revised finish schedule.
2. 20 gal Pro Mar 200 eggshell @ \$42.99 per gallon
3. 5 gal Pro Industrial WaterBased Alkyd Urethane @ 76.50 per gallon

Material Costs for The Sum Of
(\$1,242.30) Dollars

Exclusions and/or Qualifications:

- All work to be performed in one phase during normal working hours Monday to Friday 7am to 4pm
- All surfaces to be considered "Paint Ready"



TOWN OF NEWBURGH

1496 Route 300

NEWBURGH, NEW YORK 12550

(845) 564-4552

#1001

Date: 9/4/2025

Is the budget adjustment under \$7500?

Yes: _____ No: x

If yes, Please give Gil a copy to sign and deliver to the Accounting Office.

If no, Please have the board approve at the next available board meeting.

Reason why the budget transfer is needed:

Cover shortfall in various accounts.

From:	Account Number:	Chadwick Lake	4001.5497	Amount:	\$ (45,000.00)
	Account Description:		Maint.cont/lease/rental		
From:	Account Number:	DAT	Sludge Hauling	Amount:	\$ (20,000.00)
	Account Description:		4002.5457		
From:	Account Number:	DAT	4002.5459	Amount:	\$ (10,000.00)
	Account Description:		Chemicals		
From:	Account Number:	DAT	4002.5481	Amount:	\$ (10,000.00)
	Account Description:		Utilities		
FROM Sub Total					\$ (85,000.00)
To:	Account Description:	Chadwick Lake	4001.5457		\$ 45,000.00
	Account Description:		Sludge Hauling		
To:	Account Number:	Chadwick Lake	4001.5459	Amount:	\$ 40,000.00
	Account Description:		Chemicals		
TO Sub Total					\$ 85,000.00

Please note: The total of from/to should be equal.

Total 0.0

Department Head Signature

Mike B. P.

Gil Piaquadio, Town Supervisor